

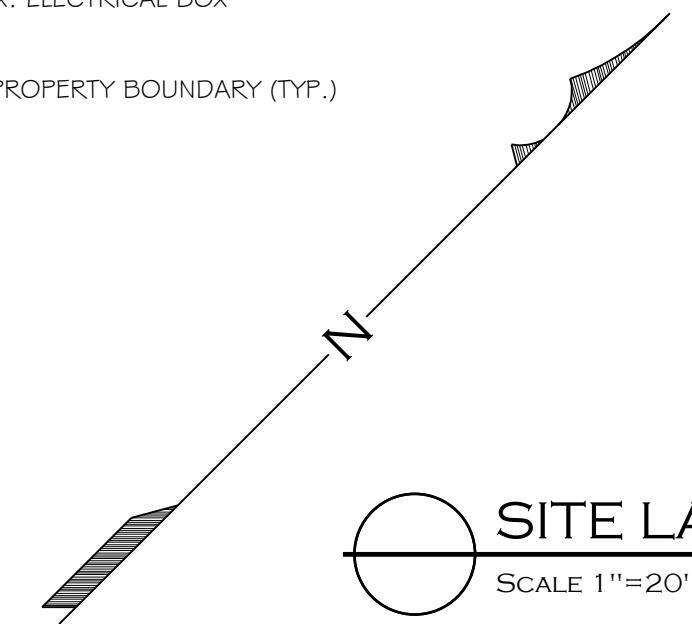

Know what's below.
Call before you dig.

- NOTES:
1. CONCRETE EXPANSION JOINTS SHALL BE PRE-MOLDED, NON ASPHALTIC, RUBBERIZED, WATERPROOF, AND SEALED WITH NP1 LIGHT GRAY SELF LEVELING RUBBERIZED CAULK. LOCATE EXPANSION JOINTS MAX. 30 FT. APART, AND ABUTTING ALL FIXED STRUCTURES.
 2. LOCATE ALL EXPANSION AND CONTRACTION JOINTS A SHOWN ON PLANS AND DETAILS.
 3. SEE DRAINAGE PLAN (1) (A-9) FOR MODULAR SOIL CELL, BIOSWALE, AND UNDERDRAIN LAYOUT AND INFORMATION.
 4. CITY TO COORDINATE W/ TELECOMMUNICATION UTILITIES REGARDING RAISING/REMOVING/BURYING EXISTING OVERHEAD LINES. CONTRACTOR TO REVIEW WICITY PRIOR TO CONSTRUCTION.
 5. CONTRACTOR SHALL ENSURE SAFE SITE CONDITIONS DURING CONSTRUCTION.
 6. CONTRACTOR SHALL COORDINATE WITH CITY AND BUSINESS OWNERS TO SCHEDULE AND MAINTAIN SAFE ACCESS TO BUSINESSES DURING CONSTRUCTION.
 7. CONTRACTOR SHALL INSTALL DOWEL BARS AT ALL COLD CONCRETE JOINTS. DOWEL BARS SHALL BE COATED WITH EITHER STAINLESS STEEL OR EPOXY.
 8. UTILITY INFRASTRUCTURE (SEE CIVIL SET) LOCATIONS MAY IMPACT HARDSCAPE/LANDSCAPE ELEMENTS. ANY REQUIRED FIELD ADJUSTMENTS TO BE REVIEWED/APPROVED BY CITY ENGINEER OR L.A.
 9. ALL ROAD STRIPING IS TO BE REVIEWED BY COH AND/OR NCDOT PRIOR TO APPLICATION.

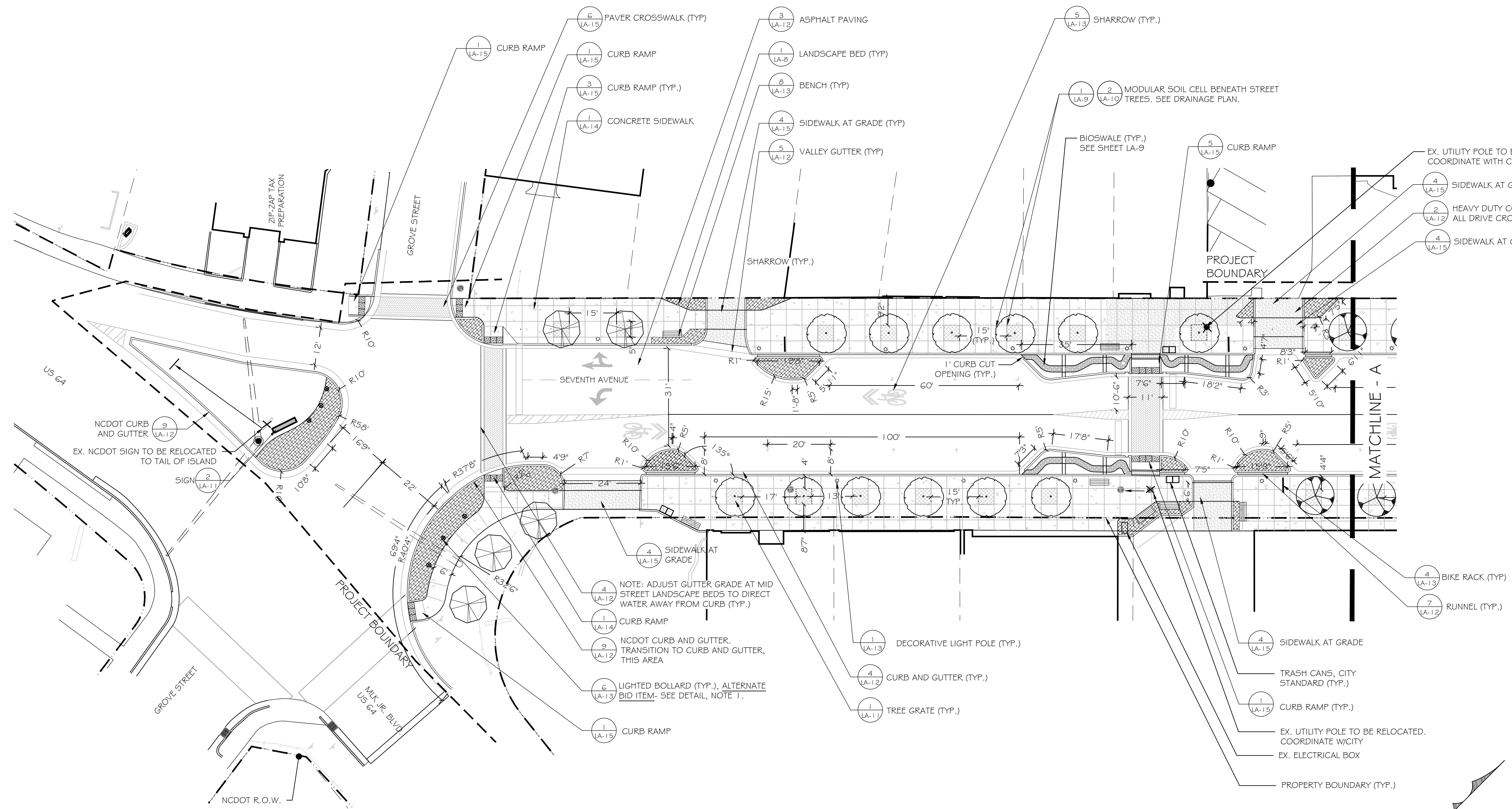

SITE LAYOUT
SCALE 1"=20'-0"

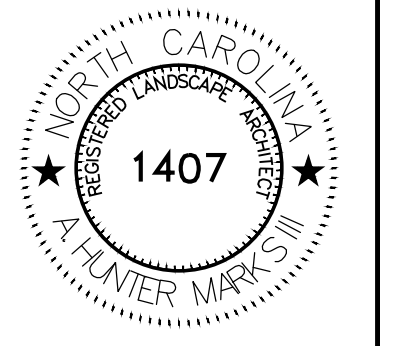
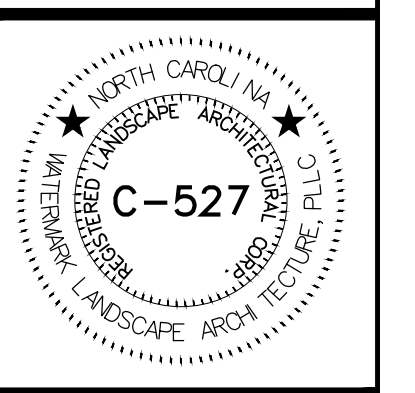
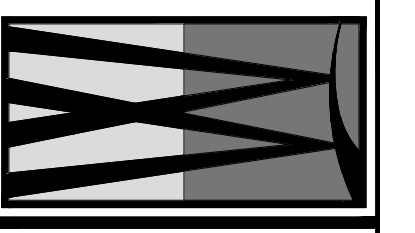

Date:	08-23-2021	Drawn By:	RBA
Job No:	160628MU	Checked By:	AHM
Revisions			
Rev:	10-27-2021	(RBA)	
Rev:	06-20-2023	(RBA)	
Rev:	07-06-2023	(RBA)	
Rev:	07-26-2023	(RBA)	

C:\Users\ebank\OneDrive\Documents\Projects\Seventh Avenue\Seventh Avenue.dwg 7/28/2023 11:11 AM



Know what's below.
Call before you dig.

NOTES:

1. CONCRETE EXPANSION JOINTS SHALL BE PRE-MOLDED, NON ASPHALTIC, RUBBERIZED, WATERPROOF, AND SEALED WITH NP1 LIGHT GRAY SELF LEVELING RUBBERIZED CAULK. LOCATE EXPANSION JOINTS MAX. 30 FT. APART, AND ABUTTING ALL FIXED STRUCTURES.
2. LOCATE ALL EXPANSION AND CONTRACTION JOINTS AS SHOWN ON PLANS AND DETAILS.
3. SEE DRAINAGE PLAN (1) (A-5) FOR MODULAR SOIL CELL, BIOSWALE, AND UNDERDRAIN LAYOUT AND INFORMATION.
4. CITY TO COORDINATE W/ TELECOMMUNICATION UTILITIES REGARDING RAISING/REMOVING/BURYING EXISTING OVERHEAD LINES. CONTRACTOR TO REVIEW W/CITY PRIOR TO CONSTRUCTION.
5. CONTRACTOR SHALL ENSURE SAFE SITE CONDITIONS DURING CONSTRUCTION.
6. CONTRACTOR SHALL COORDINATE WITH CITY AND BUSINESS OWNERS TO SCHEDULE AND MAINTAIN SAFE ACCESS TO BUSINESSES DURING CONSTRUCTION.
7. CONTRACTOR SHALL INSTALL DOWEL BARS AT ALL COLD CONCRETE JOINTS. DOWEL BARS SHALL BE COATED WITH EITHER STAINLESS STEEL OR EPOXY.
8. UTILITY INFRASTRUCTURE (SEE CIVIL SET) LOCATIONS MAY IMPACT HARDSCAPE/LANDSCAPE ELEMENTS. ANY REQUIRED FIELD ADJUSTMENTS TO BE REVIEWED/APPROVED BY CITY ENGINEER OR L.A.
9. ALL ROAD STRIPING IS TO BE REVIEWED BY COH AND/OR NCDOT PRIOR TO APPLICATION.

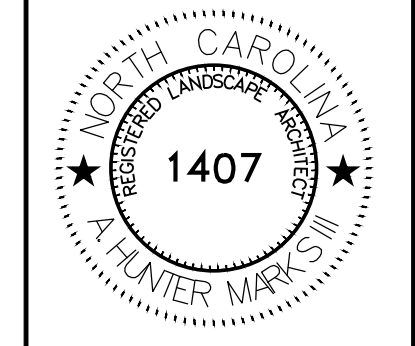
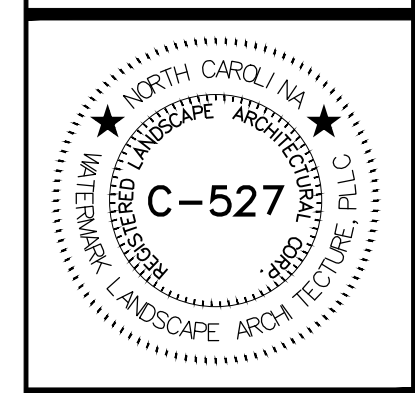
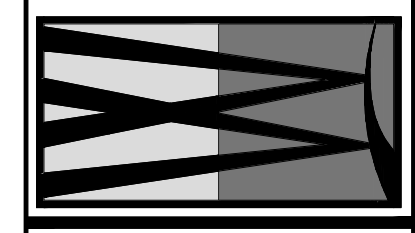
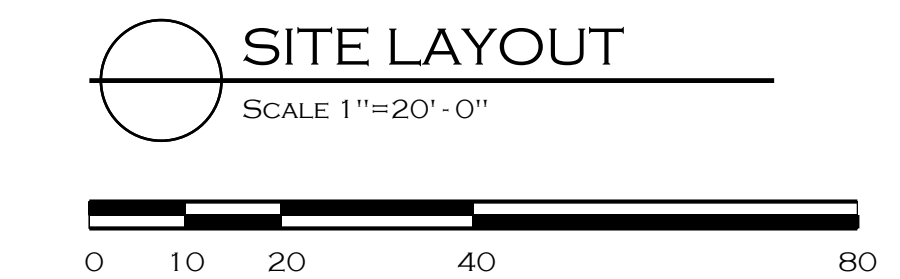
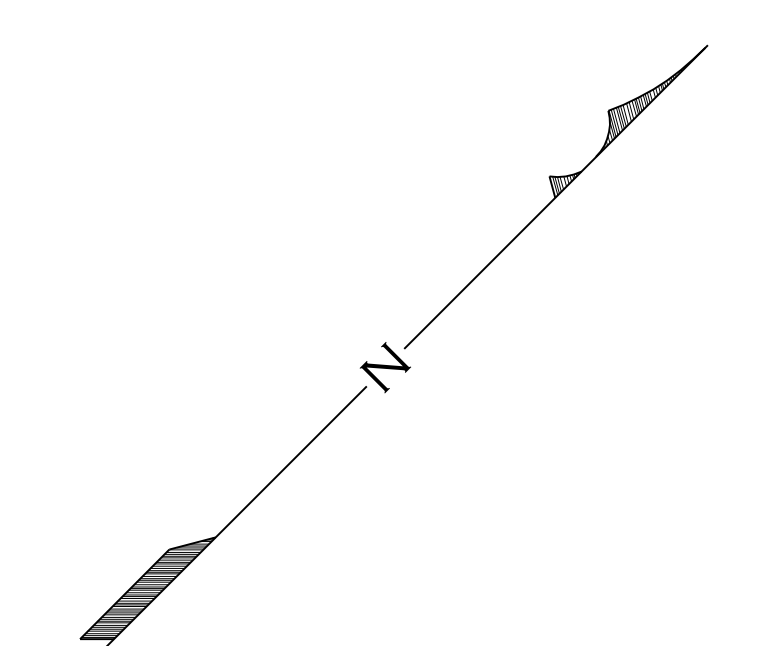
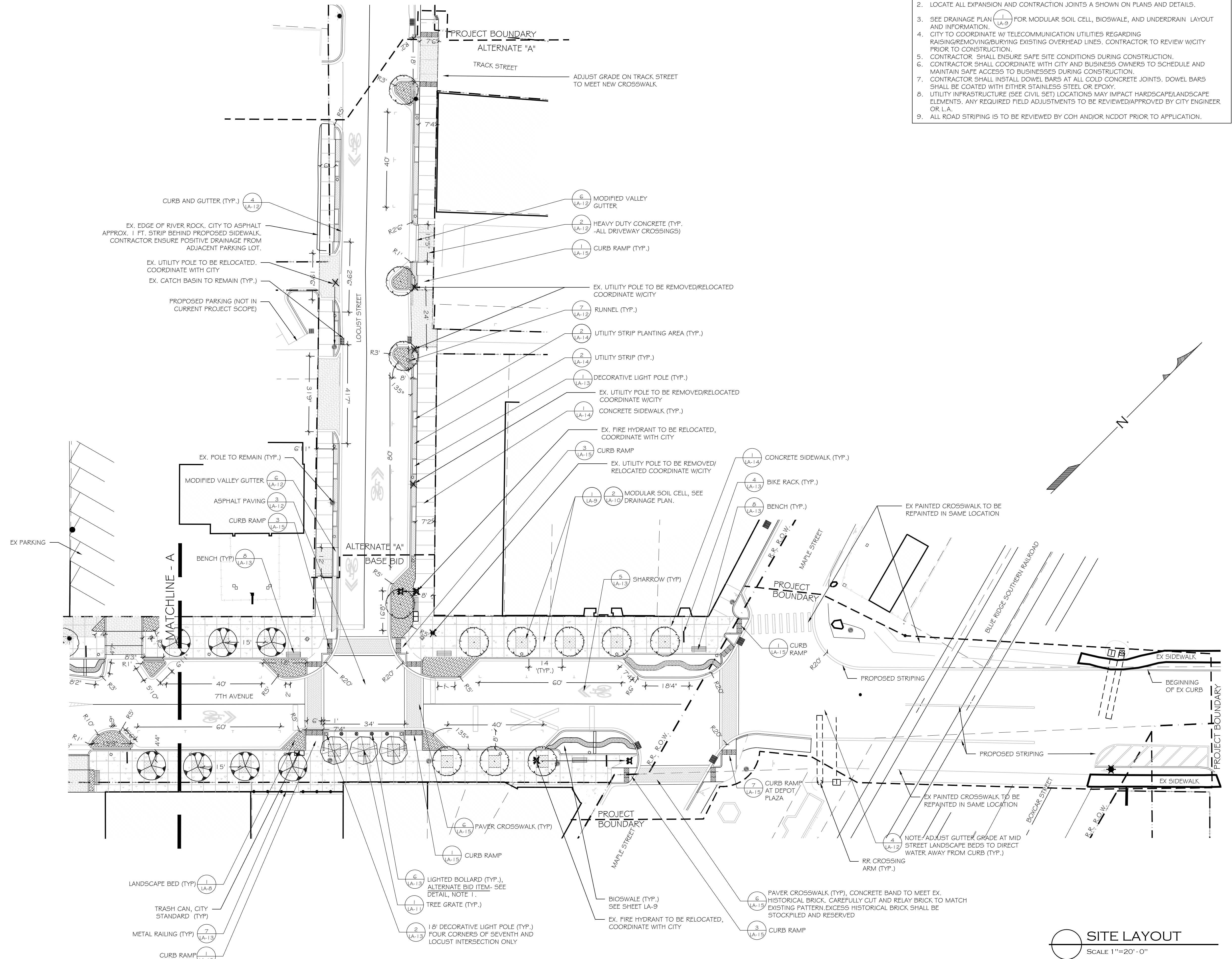

Date:	08-23-2021	Drawn By:	RBA
Job No:	160628MU	Checked By:	ATM
Revisions			
Rev.:	10-27-2021	By:	(RBA)
Rev.:	06-20-2023	By:	(RBA)
Rev.:	07-06-2023	By:	(RBA)
Rev.:	07-26-2023	By:	(RBA)

C:\Users\ebach\OneDrive\Projects\Watermark\Projects\Seventh Avenue\Drawings\Construction\082321\082321_01724_DRAFT_WA-5_Sewer_Arch.dwg 7/28/2023 11:10 AM