

CITY OF HENDERSONVILLE
Cherry and Beech Sidewalks Project

ADDENDUM NO. 2

February 21, 2025

The attention of all Bidders on the above Contract to this Addendum No. 2:

A. Bid Opening

- a. Bids will now be opened March 7th, 2025 at 10:00 AM local time.
- b. Delete C111 Advertisement for Bids from the project manual and replace with the new C111 Advertisement for Bids attached.

B. Drawings

- a. Drawings have been updated to remove milling from the Work, clarify asphalt patching, clarify demolition extents, and show thermoplastic crosswalk lines.
- b. Demolition hatch extended to match sawcut boundary sheets C4, C5, and C6.
- c. MILL AND ASPHALT OVERLAY removed from sheets C7, C8, and C9.
- d. SAWCUT ASPHALT AND REPLACE 1' FROM EOP removed from sheets C7, C8, and C9.
- e. END 6-IN HDPE PERFORATED PIPE FOR 2'X2' BIOSWALE removed from sheet C7.
- f. ASPHALT PATCH added to sheets C7, C8, and C9.
- g. 6" WHITE PAINT CROSSWALK removed from sheets C7, C8, and C9.
- h. THERMOPLASTIC CROSSWALK added to sheets C7, C8, and C9.
- i. 24" STOPBAR added to sheets C7, C8, and C9.
- j. This updated set is attached to this addendum.

C. Bid Schedule

- a. The Bid Schedule has been updated to strike through bid item 19 – Mill Asphalt Pavement 1.5" Depth.
- b. Do not provide a price for bid item 19 – Mill Asphalt Pavement 1.5" Depth.
- c. QTY for bid item 4 – Asphalt pavement and Curb Removal has been updated to reflect the extension of the demolition hatch.
- d. QTY for bid item 25, 26, and 28 have been updated.
- e. Delete the Bid Schedule from the project manual and replace with the new Bid Schedule attached.

D. Technical Specifications

- a. In Technical Specification section 01630 Measurement and Payment delete item b for bid item 4 - Asphalt Pavement and Curb Removal. Replace with the following text:
 - b. The unit prices bid for Asphalt Pavement and Curb Removal shall include all costs in connection with the total depth removal including removal and disposal of old curb, asphalt pavement, and concrete base course. Additional excavation of existing subgrade material will be necessary in some locations to install the new asphalt pavement surface at proposed grades and shall be included in the price bid per square yard of Asphalt Removal. No separate payment will be made.

CITY OF HENDERSONVILLE
CHERRY AND BEECH SIDEWALKS PROJECT
ADDENDUM NO. 2
February 21, 2025
Page 2 of 3

- b. The word cutting was removed as it is covered in bid item 3 – Sawcut Asphalt and Concrete.
- c. In Technical Specification section 01630 Measurement and Payment delete item b for bid item 5 – Concrete Sidewalk and Drive Removal. Replace with the following text:
 - b. The unit prices bid for Concrete Sidewalk and Drive Removal shall include all costs in connection with the total depth removal including removal, and disposal of old concrete sidewalk, drive and base material. Additional excavation of existing subgrade material will be necessary in some locations to install the new concrete sidewalk and drives at proposed grades and shall be included in the price bid per square yard of Concrete Sidewalk and Drive Removal. No separate payment will be made.
- d. The word cutting was removed as it is covered in bid item 3 - Sawcut Asphalt and Concrete.
- e. In Technical Specification section 01630 Measurement and Payment add item c for bid item 17 – Compacted ABC Stone:
 - c. Measured tons (TN) shall calculated from volume installed multiplied by a specific weight of 140 lbs. per cubic foot and converted to tons.
- f. In Technical Specification section 02510 Bituminous Paving delete item a for 11. Striping. Replace with the following text:
 - a. All line striping (dashed white and solid yellow) shall be replaced at the end of each work day by the Contractor using temporary pavement markings. Final striping shall be thermoplastic meeting NCDOT and MUTCD specifications and shall be as shown on the drawings. Work associated with striping shall include layout, furnishing paint and/or thermoplastic material, placement, and protection of work until striping has sufficiently cured for traffic. Final striping shall be thermoplastic meeting NCDOT and MUTCD specifications and shall be as shown on the drawings. Crosswalks shall conform to Figure 3C-1 of the MUTCD 11th Edition PART 3.
- g. A reference to MUTCD was added in two locations and MUTCD Figure 3C-1 was specifically referenced.

E. Answers and Clarifications

- a. All work will occur within the City of Hendersonville Right of Way or easement acquired by the City of Hendersonville. The contractor will need to adhere to local erosion control regulations. The contractor shall be properly licensed to do the Work in the State of North Carolina and shall be in good standing with the issuing licensure board.
- b. Asphalt removal for 12” off the face of curb will be measured and paid for by bid item 4 - Asphalt Pavement and Curb Removal see detail 6/13.
- c. Asphalt patching for 12” off face of curb and gutter will be measured and paid for by

CITY OF HENDERSONVILLE
CHERRY AND BEECH SIDEWALKS PROJECT
ADDENDUM NO. 2

February 21, 2025

Page 3 of 3

- bid item 18 - Asphalt Pavement.
- d. Using compacted ABC stone to maintain access to existing buildings and homes will be measured and paid for by bid item 17 – Compacted ABC Stone.
 - e. Compacted ABC stone placed under new sidewalk will be measured and paid for by bid item 17 – Compacted ABC Stone.
 - f. For topsoil requirements on the final 1" of grade, including shoulder backfill along sidewalks, see Technical Specification Section 02230 Seeding. Seeding and Mulching is incidental to the Work.
 - g. Crosswalks have been more clearly shown as thermoplastic in the drawings. See updated drawings for thermoplastic requirements and locations. See NCDOT specifications for thermoplastic as well as the MUTCD standards for crosswalks. Stop Bars will be included in bid item 16.
 - h. Asphalt Milling will not be required for this project. Bid item 19 – Mill Asphalt Pavement 1.5" Depth has been struck through on the Bid Schedule. Do not provide a price for Bid item 19 – Mill Asphalt Pavement 1.5" Depth.
 - i. Existing asphalt drives will be sawcut and concrete will be placed using the exiting asphalt as the finish edge. No asphalt patching is anticipated for tying into existing asphalt drives.
 - j. The plan callout for 6" HDPE perforated pipe at the bioretention cells has been removed. See detail 7/13 for the cross section of the bioretention cells.
 - k. Bid Item 25 – Cast Iron Curb Inlet is intended only for installing a Frame Grate Hood on existing stormwater structures. Any Cast Iron Curb Inlets or Frame Grate Hoods for proposed structures will be included in bid item 26 – Precast Stormwater Structure.

F. Davis Bacon General Decision

- a. Replace item 21C: Davis Bacon General Decision Number: NC20250079 for heavy construction (PDF pages 204-208) with the attached Davis Bacon General Decision Number: NC20250087 for highway construction.

G. Acknowledgement by Bidder

- a. Each bidder is required to acknowledge receipt of this Addendum No. 2 and previous addenda in the space provided in the Bid Form.

CITY OF HENDERSONVILLE



Richard Shook, PE
Civil Engineer
February 2025

ADVERTISEMENT FOR BIDS #180171014001
CITY OF HENDERSONVILLE
HENDERSONVILLE, NORTH CAROLINA
CHERRY AND BEECH STREET SIDEWALK PROJECT

General Notice

City of Hendersonville (Owner) is requesting sealed Bids for the construction of the following Project:

CHERRY AND BEECH STREET SIDEWALK PROJECT
City Project Number 18017

Bids for the construction of the Project will be received at the City of Hendersonville Hall, 2nd floor meeting room (council room), located at 160 6th Ave E, Hendersonville NC 28792, until **March 7, 2025, at 10:00 AM** local time. At that time and place the Bids received will be publicly opened and read. Bids submitted in advance should be sent to 305 Williams Street, Hendersonville, NC 28792 to the attention of Richard Shook. If less than three sealed bids are received at the time of bid opening, no bids will be opened.

The Project includes the following Work:

The City of Hendersonville's Cherry and Beech Street Sidewalk project consists of the construction of approximately 1,500 feet of new sidewalks, nine (9) pedestrian ramps, and fifty (50) feet of stormwater improvements in the Ashe Street neighborhood.

The Project has an expected duration of 120 calendar days.

Obtaining Plans, Specifications, and Bidding Documents

Complete digital plans, specifications, and bidding documents are available through the online electronic bid service <http://www.questcdn.com/>. QuestCDN shall be considered the Issuing Office for the purposes of the bid documents. You may download the digital plan documents for a non-refundable charge of \$22.00 by inputting Quest project **#9455422** on the website's Project Search page. Please contact QuestCDN.com at 952-233-1632 or info@questcdn.com for assistance in obtaining a free membership registration and downloading this digital project information.

Prospective bidders are responsible for obtaining complete Plans, Specifications, and Bidding Documents, including any Addenda.

Each Bidder must be licensed under Chapter 87 of the North Carolina General Statute. All bids must include a non-collusion affidavit and a complete Certification Regarding Lobbying.

Each proposal shall be accompanied by a bid deposit in the amount of not less than five percent (5%) of the amount of the bid in the form and subject to the conditions provided in the Instruction to Bidders. The City reserves the right to waive any informality and to reject any and all proposals for any reason determined to be in the best interest of the City, except for the purpose of evading the bid laws. If awarded, the project will be awarded to the lowest responsive and responsible bidder taking into consideration quality, performance and the time specified in the proposals (if required to be specified). Non-responsive bids will be rejected.

It is the policy of the City to award public building contracts without regard to race, religion, color, creed, national origin, sex, age or disabling condition.

Notice of Federal Funding

This work is funded in whole or in part with federal funds, and therefore, all applicable federal provisions apply, including, but not limited to:

Equal Employment Opportunity (41 C.F.R. Part 60); Davis-Bacon Act (40 U.S.C. 3141-3148); Copeland “Anti-Kickback” Act (40 U.S.C. 3145); Contract Work Hours and Safety Standards Act (40 U.S.C. 3701-3708); Clean Air Act (42 U.S.C. 7401-7671q.) and the Federal Water Pollution Control Act (33 U.S.C. 1251-1387); Debarment and Suspension (Executive Orders 12549 and 12689); Byrd Anti-Lobbying Amendment (31 U.S.C. 1352); Procurement of Recovered Materials (2 C.F.R. § 200.322); and Record Retention Requirements (2 CFR § 200.324)

Pre-bid Conference

A pre-bid conference for the Project will be held on **February 13, 2025, at 1:00 PM** local time via Microsoft Teams. Attendance at the pre-bid conference is encouraged but not mandatory. The virtual pre-bid conference may be accessed via the following link or call-in number:

Microsoft Teams [Need help?](#)

[Join the meeting now](#)

Meeting ID: 219 764 270 228

Passcode: NR9AH3jJ

Dial in by phone

[+1 980-272-0984,,452296195#](#) United States, Charlotte

[Find a local number](#)

Phone conference ID: 452 296 195#

For organizers: [Meeting options](#) | [Reset dial-in PIN](#)

This Advertisement is issued by:

Owner: City of Hendersonville

By: Richard Shook, PE

Title: Civil Engineer

Date: February 3, 2025

Cherry and Beech Street Sidewalks
City of Hendersonville

ITEM	ITEM DESCRIPTION	UNIT OF MEASURE	ESTIMATED QUANTITY	UNIT PRICE	PRICE
1	Mobilization (shall not exceed 3% of total bid)	LS	1		
2	Traffic Control	LS	1		

DEMOLITION AND EARTHWORK

3	Sawcut Asphalt and Concrete	LF	1388		
4	Asphalt Pavement and Curb Removal	SY	580		
5	Concrete Sidewalk and Drive Removal	SY	261		
6	Tree Removal	EA	3		
7	Grading	LS	1		
8	Select Material	CY	42		
9	Remove and Reinstall Mailbox	EA	1		

SIDEWALK CONSTRUCTION

10	Concrete Sidewalk 4"	SY	553		
11	Concrete Sidewalk 6"	SY	29		
12	Concrete Driveway Apron 6"	SY	118		
13	Concrete Curb and Gutter	LF	678		
14	Asphalt Curb and Gutter	LF	53		
15	Pedestrian Ramp	EA	9		
16	Crosswalk Paint Lines	LS	1		
17	Compacted ABC Stone	TN	86		
18	Asphalt Pavement	TN	14		
19	Mill Asphalt Pavement 1.5" Depth	SY	134		
20	Root Barrier Protection	LF	10		
21	Utility Adjustments (Adjust to Grade)	EA	6		
22	Remove and Replace Traffic Sign	EA	1		

STORMWATER AND EROSION CONTROL

23	Silt Fence and Erosion Control BMPs	LS	1		
24	Bio-retention Cell	SF	98		
25	Cast Iron Curb Inlet	EA	1		
26	Precast Stormwater Structure	EA	2		
27	Concrete Stormwater Pipe 12"	LF	40		
28	Connect to Existing Structure	EA	1		

TOTAL ESTIMATED CONSTRUCTION COST

"General Decision Number: NC20250087 01/03/2025

Superseded General Decision Number: NC20240087

State: North Carolina

Construction Type: Highway

Counties: Alexander, Buncombe, Burke, Caldwell, Catawba, Haywood, Henderson and Madison Counties in North Carolina.

HIGHWAY CONSTRUCTION PROJECTS (excluding tunnels, building structures in rest area projects & railroad construction; bascule, suspension & spandrel arch bridges designed for commercial navigation, bridges involving marine construction; and other major bridges).

Note: Contracts subject to the Davis-Bacon Act are generally required to pay at least the applicable minimum wage rate required under Executive Order 14026 or Executive Order 13658. Please note that these Executive Orders apply to covered contracts entered into by the federal government that are subject to the Davis-Bacon Act itself, but do not apply to contracts subject only to the Davis-Bacon Related Acts, including those set forth at 29 CFR 5.1(a)(1).

If the contract is entered into on or after January 30, 2022, or the contract is renewed or extended (e.g., an option is exercised) on or after January 30, 2022:	<ul style="list-style-type: none">. Executive Order 14026 generally applies to the contract.. The contractor must pay all covered workers at least \$17.75 per hour (or the applicable wage rate listed on this wage determination, if it is higher) for all hours spent performing on the contract in 2025.
If the contract was awarded on or between January 1, 2015 and January 29, 2022, and the contract is not renewed or extended on or after January 30, 2022:	<ul style="list-style-type: none">. Executive Order 13658 generally applies to the contract.. The contractor must pay all covered workers at least \$13.30 per hour (or the applicable wage rate listed on this wage determination, if it is higher) for all

	hours spent performing on that contract in 2025.
--	---

The applicable Executive Order minimum wage rate will be adjusted annually. If this contract is covered by one of the Executive Orders and a classification considered necessary for performance of work on the contract does not appear on this wage determination, the contractor must still submit a conformance request.

Additional information on contractor requirements and worker protections under the Executive Orders is available at <http://www.dol.gov/whd/govcontracts>.

Modification Number	Publication Date
0	01/03/2025

SUNC2014-002 11/13/2014

	Rates	Fringes
BLASTER.....	\$ 20.93	
CARPENTER.....	\$ 13.48 **	
CEMENT MASON/CONCRETE FINISHER...	\$ 14.40 **	
ELECTRICIAN		
Electrician.....	\$ 18.79	2.62
Telecommunications		
Technician.....	\$ 14.67 **	1.67
IRONWORKER.....	\$ 12.48 **	
LABORER		
Asphalt Raker and Spreader..	\$ 11.76 **	
Asphalt Screed/Jackman.....	\$ 15.38 **	.08
Carpenter Tender.....	\$ 10.50 **	
Cement Mason/Concrete		
Finisher Tender.....	\$ 11.04 **	
Common or General.....	\$ 11.90 **	
Guardrail/Fence Installer...	\$ 13.09 **	
Pipelayer.....	\$ 12.87 **	
Traffic Signal/Lighting		
Installer.....	\$ 15.33 **	.22
PAINTER		
Bridge.....	\$ 20.67	

POWER EQUIPMENT OPERATOR

Asphalt Broom Tractor.....	\$ 10.00	**	
Bulldozer Fine.....	\$ 16.28	**	
Bulldozer Rough.....	\$ 14.51	**	
Concrete Grinder/Groover....	\$ 19.20		
Crane Boom Trucks.....	\$ 18.19		
Crane Other.....	\$ 18.69		
Crane Rough/All-Terrain....	\$ 19.19		
Drill Operator Rock.....	\$ 15.00	**	
Drill Operator Structure....	\$ 21.07		
Excavator Fine.....	\$ 16.02	**	
Excavator Rough.....	\$ 14.67	**	
Grader/Blade Fine.....	\$ 19.86		
Grader/Blade Rough.....	\$ 15.12	**	
Loader 2 Cubic Yards or Less.....	\$ 12.38	**	
Loader Greater Than 2 Cubic Yards.....	\$ 17.91		
Material Transfer Vehicle (Shuttle Buggy).....	\$ 15.44	**	
Mechanic.....	\$ 17.86		
Milling Machine.....	\$ 15.08	**	
Off-Road Hauler/Water Tanker.....	\$ 11.95	**	
Oiler/Greaser.....	\$ 15.05	**	
Pavement Marking Equipment..	\$ 11.99	**	
Paver Asphalt.....	\$ 17.84		.08
Paver Concrete.....	\$ 18.20		
Roller Asphalt Breakdown....	\$ 15.00	**	.08
Roller Asphalt Finish.....	\$ 16.08	**	.07
Roller Other.....	\$ 12.51	**	.03
Scraper Finish.....	\$ 12.86	**	
Scraper Rough.....	\$ 13.83	**	
Slip Form Machine.....	\$ 20.38		
Tack Truck/Distributor Operator.....	\$ 14.81	**	.02

TRUCK DRIVER

GVWR of 26,000 Lbs or Greater.....	\$ 13.65	**
GVWR of 26,000 or Less.....	\$ 12.48	**

WELDERS - Receive rate prescribed for craft performing
operation to which welding is incidental.

=====

** Workers in this classification may be entitled to a higher

minimum wage under Executive Order 14026 (\$17.75) or 13658 (\$13.30). Please see the Note at the top of the wage determination for more information. Please also note that the minimum wage requirements of Executive Order 14026 are not currently being enforced as to any contract or subcontract to which the states of Texas, Louisiana, or Mississippi, including their agencies, are a party.

Note: Executive Order (EO) 13706, Establishing Paid Sick Leave for Federal Contractors applies to all contracts subject to the Davis-Bacon Act for which the contract is awarded (and any solicitation was issued) on or after January 1, 2017. If this contract is covered by the EO, the contractor must provide employees with 1 hour of paid sick leave for every 30 hours they work, up to 56 hours of paid sick leave each year. Employees must be permitted to use paid sick leave for their own illness, injury or other health-related needs, including preventive care; to assist a family member (or person who is like family to the employee) who is ill, injured, or has other health-related needs, including preventive care; or for reasons resulting from, or to assist a family member (or person who is like family to the employee) who is a victim of, domestic violence, sexual assault, or stalking. Additional information on contractor requirements and worker protections under the EO is available at <https://www.dol.gov/agencies/whd/government-contracts>.

Unlisted classifications needed for work not included within the scope of the classifications listed may be added after award only as provided in the labor standards contract clauses (29CFR 5.5 (a) (1) (iii)).

The body of each wage determination lists the classifications and wage rates that have been found to be prevailing for the type(s) of construction and geographic area covered by the wage determination. The classifications are listed in alphabetical order under rate identifiers indicating whether the particular rate is a union rate (current union negotiated rate), a survey rate, a weighted union average rate, a state adopted rate, or a supplemental classification rate.

Union Rate Identifiers

A four-letter identifier beginning with characters other than ""SU"", ""UAVG"", ?SA?, or ?SC? denotes that a union rate was prevailing for that classification in the survey. Example: PLUM0198-005 07/01/2024. PLUM is an identifier of the union

whose collectively bargained rate prevailed in the survey for this classification, which in this example would be Plumbers. 0198 indicates the local union number or district council number where applicable, i.e., Plumbers Local 0198. The next number, 005 in the example, is an internal number used in processing the wage determination. The date, 07/01/2024 in the example, is the effective date of the most current negotiated rate.

Union prevailing wage rates are updated to reflect all changes over time that are reported to WHD in the rates in the collective bargaining agreement (CBA) governing the classification.

Union Average Rate Identifiers

The UAVG identifier indicates that no single rate prevailed for those classifications, but that 100% of the data reported for the classifications reflected union rates. EXAMPLE: UAVG-OH-0010 01/01/2024. UAVG indicates that the rate is a weighted union average rate. OH indicates the State of Ohio. The next number, 0010 in the example, is an internal number used in producing the wage determination. The date, 01/01/2024 in the example, indicates the date the wage determination was updated to reflect the most current union average rate.

A UAVG rate will be updated once a year, usually in January, to reflect a weighted average of the current rates in the collective bargaining agreements on which the rate is based.

Survey Rate Identifiers

The ""SU"" identifier indicates that either a single non-union rate prevailed (as defined in 29 CFR 1.2) for this classification in the survey or that the rate was derived by computing a weighted average rate based on all the rates reported in the survey for that classification. As a weighted average rate includes all rates reported in the survey, it may include both union and non-union rates. Example: SUFL2022-007 6/27/2024. SU indicates the rate is a single non-union prevailing rate or a weighted average of survey data for that classification. FL indicates the State of Florida. 2022 is the year of the survey on which these classifications and rates are based. The next number, 007 in the example, is an internal number used in producing the wage determination. The date, 6/27/2024 in the example, indicates the survey completion date for the classifications and rates under that identifier.

?SU? wage rates typically remain in effect until a new survey is conducted. However, the Wage and Hour Division (WHD) has the

discretion to update such rates under 29 CFR 1.6(c)(1).

State Adopted Rate Identifiers

The "SA" identifier indicates that the classifications and prevailing wage rates set by a state (or local) government were adopted under 29 C.F.R 1.3(g)-(h). Example: SAME2023-007 01/03/2024. SA reflects that the rates are state adopted. ME refers to the State of Maine. 2023 is the year during which the state completed the survey on which the listed classifications and rates are based. The next number, 007 in the example, is an internal number used in producing the wage determination. The date, 01/03/2024 in the example, reflects the date on which the classifications and rates under the "SA" identifier took effect under state law in the state from which the rates were adopted.

WAGE DETERMINATION APPEALS PROCESS

1) Has there been an initial decision in the matter? This can be:

- a) a survey underlying a wage determination
- b) an existing published wage determination
- c) an initial WHD letter setting forth a position on a wage determination matter
- d) an initial conformance (additional classification and rate) determination

On survey related matters, initial contact, including requests for summaries of surveys, should be directed to the WHD Branch of Wage Surveys. Requests can be submitted via email to davisbaconinfo@dol.gov or by mail to:

Branch of Wage Surveys
Wage and Hour Division
U.S. Department of Labor
200 Constitution Avenue, N.W.
Washington, DC 20210

Regarding any other wage determination matter such as conformance decisions, requests for initial decisions should be directed to the WHD Branch of Construction Wage Determinations. Requests can be submitted via email to BCWD-Office@dol.gov or by mail to:

Branch of Construction Wage Determinations
Wage and Hour Division

U.S. Department of Labor
200 Constitution Avenue, N.W.
Washington, DC 20210

2) If an initial decision has been issued, then any interested party (those affected by the action) that disagrees with the decision can request review and reconsideration from the Wage and Hour Administrator (See 29 CFR Part 1.8 and 29 CFR Part 7). Requests for review and reconsideration can be submitted via email to dba.reconsideration@dol.gov or by mail to:

Wage and Hour Administrator
U.S. Department of Labor
200 Constitution Avenue, N.W.
Washington, DC 20210

The request should be accompanied by a full statement of the interested party's position and any information (wage payment data, project description, area practice material, etc.) that the requestor considers relevant to the issue.

3) If the decision of the Administrator is not favorable, an interested party may appeal directly to the Administrative Review Board (formerly the Wage Appeals Board). Write to:

Administrative Review Board
U.S. Department of Labor
200 Constitution Avenue, N.W.
Washington, DC 20210.

=====

END OF GENERAL DECISION"

CHERRY AND BEECH SIDEWALK IMPROVEMENTS

CITY OF HENDERSONVILLE, NC

305 WILLIAM STREET
HENDERSONVILLE, NC 28792
PROJECT 18017

CONSTRUCTION OF NEW SIDEWALKS ALONG CHERRY ST AND BEECH ST

TYPE OF WORK:
SIDEWALK - NEW CONSTRUCTION

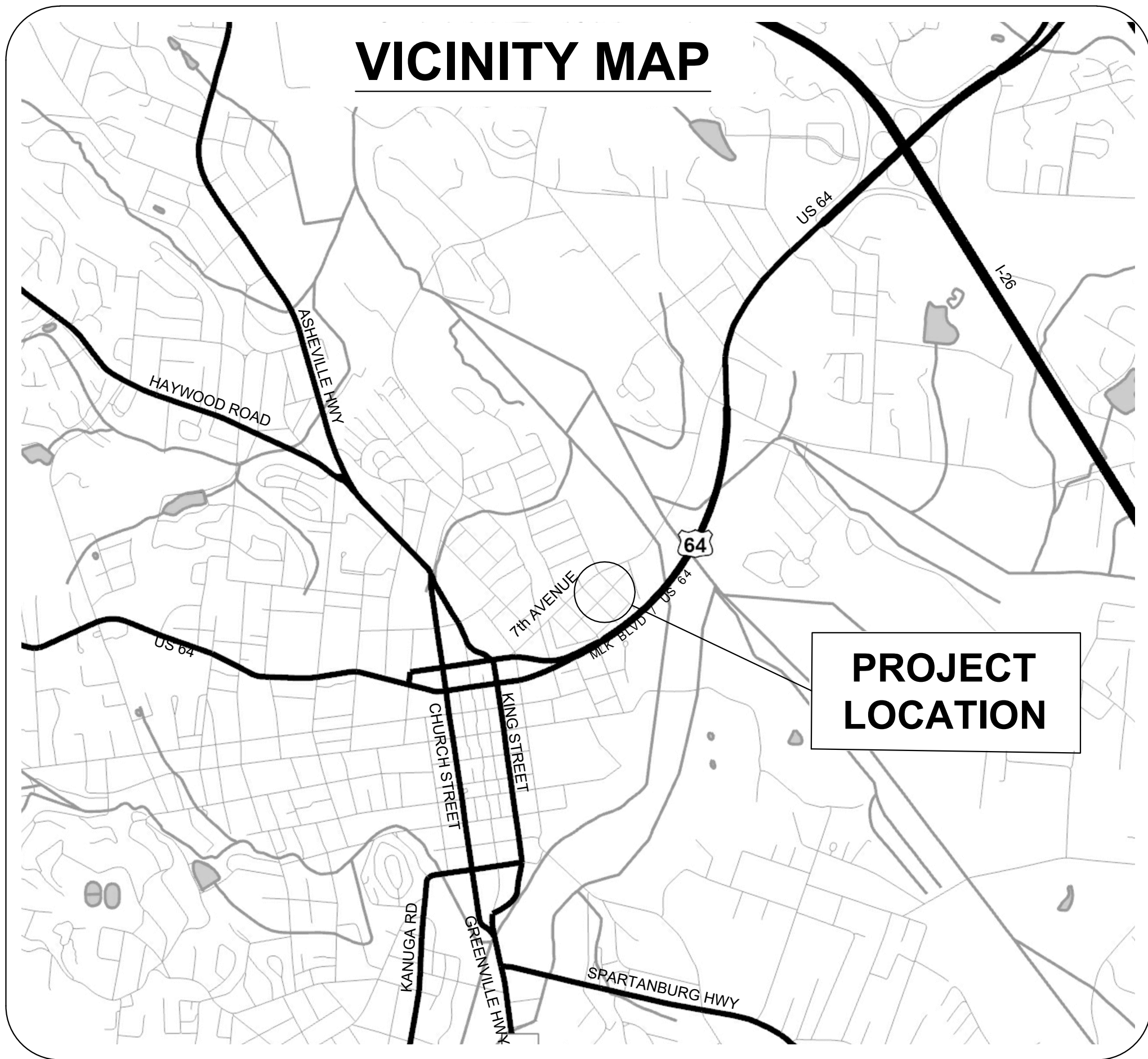

Not To Scale

INDEX OF SHEETS

- C1 TITLE SHEET
- C2 GENERAL NOTES, LEGEND AND SYMBOLOGY
- C3 INDEX MAP
- C4 - C6 DEMOLITION PLANS
- C7 - C9 PLAN SHEETS
- C10 CROSS SECTIONS
- C11 - C13 DETAILS



CITY OF HENDERSONVILLE, NC
"The City of Four Seasons"

City of Hendersonville Engineering Department
305 William Street
Hendersonville, NC 28792
(828) 697-3000 (office)
(828) 697-3066 (fax)
www.cityofhendersonville.org

CHERRY & BEECH SIDEWALK IMPROVEMENTS

TITLE

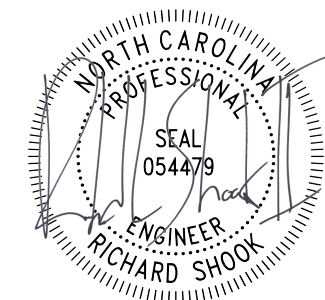

JMB	RLS	CC	2025.02.21
Dwn.	Dsgn.	Chkd.	YYYY.MM.DD
Project No.: 18017			
Revision: 01			
Sheet: 1 of 13			
Drawing No.			
C1			



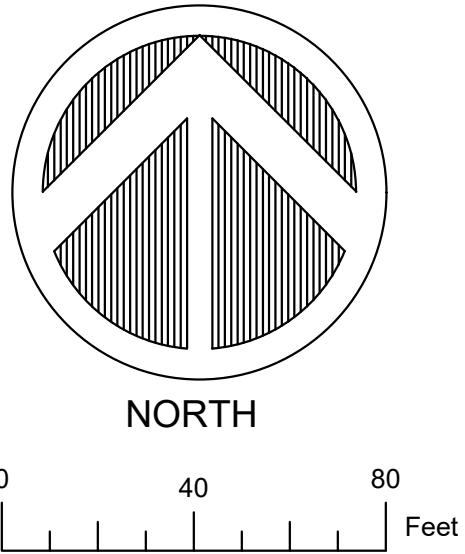

ALIGNMENT DATA						
POINT #	STATION	NORTHING	EASTING	LENGTH	DIRECTION	ALIGNMENT
P1	13+14.56	590586.28	969785.61	272.35'	S44° 51' 37"E	CL Cherry Street
P2	12+72.35	590393.23	969977.72	41.87'	S44° 45' 36"E	CL Cherry Street
P3	13+15.17	590362.82	970007.88	384.83'	S44° 56' 06"E	CL Cherry Street
P4	12+72.70	590090.40	970279.68			CL Cherry Street
P10	10+00.00	590378.80	969535.86	298.60'	S43° 53' 04"E	CL Beech Street
P11	23+39.18	590163.59	969742.85	37.24'	S44° 50' 34"E	CL Beech Street
P12	22+98.60	590133.94	969772.29	359.61'	S44° 29' 50"E	CL Beech Street
P13	23+40.39	589877.43	970024.34			CL Beech Street
P20	23+01.94	589949.89	970040.38	400.00'	S45° 47' 44"E	CL Jonas Street
P21	20+00.00	589671.00	969753.63			CL Jonas Street



CITY OF HENDERSONVILLE, NC
"The City of Four Seasons"
City of Hendersonville Engineering Department
305 Williams Street
Hendersonville, NC 28792
(828) 697-3000 (office)
(828) 697-3065 (fax)
www.cityofhendersonville.org

NO.	DATE	DESCRIPTION	BY	RLS
1	02/21/2025	ISSUED FOR BID		

CHERRY & BEECH SIDEWALK IMPROVEMENTS

INDEX

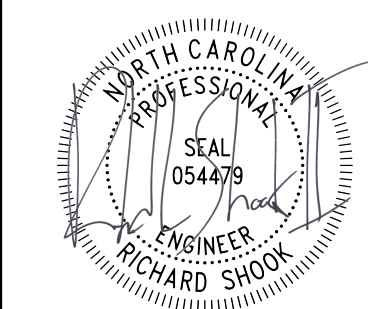

JMB_RLS_CC_2025.02.21
Dwn. Dsgn. Chkd. YYYY.MM.DD
Project No.: 18017
Revision: 01
Sheet: 3 of 13
Drawing No.
C3

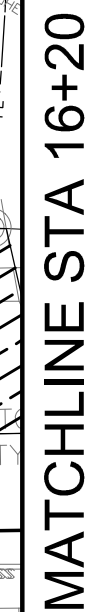

1. REPLACEMENT OF CONCRETE SIDEWALKS, CURB AND GUTTER, AND ASPHALT PAVEMENT SHALL BE COMPLETELY COORDINATED BY THE CONTRACTOR, THE RESULTING APPEARANCE OF THE PUBLIC STREETS, PARKING AREAS, CURB/GUTTER, AND SIDEWALKS SHALL BE FREE OF OBVIOUS HOLES, SCARS, CHIPPED OR DAMAGED AREAS AND BE ARCHITECTURALLY FINISHED TO MATCH EXISTING ADJACENT SURFACES. THE CONTRACTOR SHALL CLOSELY COORDINATE THEIR DEMOLITION AND CONSTRUCTION ACTIVITIES WITH THE ENGINEER TO ENSURE THAT THE PROJECT GOES SMOOTHLY AND WITHOUT CONFLICT.
2. THE CONTRACTOR SHALL PROVIDE ACCESS TO ALL PRIVATE PROPERTY, INCLUDING BUSINESSES AND RESIDENCES AT ALL TIMES DURING DEMOLITION AND CONSTRUCTION. THE CONTRACTOR SHALL PROVIDE AND MAINTAIN A SUFFICIENT LAYER OF COMPACTED ABC STONE, AS APPROVED BY THE ENGINEER, TO ALLOW ACCESS FROM THE STREETS TO THE BUILDING ENTRANCES UNTIL THE AREAS ARE READY FOR PLACEMENT OF NEW CONCRETE. THE CONTRACTOR SHALL PROVIDE ACCESS TO ANY FACILITIES FOR CONSTRUCTION THAT WILL TEMPORARILY BLOCK ACCESS TO ANY BUILDING ENTRANCE FOR ANY PERIOD OF TIME. ANY TEMPORARY RESTRICTION OF BUILDING ACCESS WILL NOT BE ALLOWED UNTIL PERMISSION IS GRANTED BY THE ENGINEER. THE CONTRACTOR SHALL PROVIDE AT LEAST 24-HOURS NOTICE TO THE OWNERS AND OCCUPANTS OF ANY BUSINESSES OR RESIDENCES THAT ARE AFFECTED BY ANY TEMPORARY BLOCK OF ACCESS. ANY COSTS ASSOCIATED WITH PROVIDING ACCESS, INCLUDING COORDINATION WITH OWNERS/OCCUPANTS, AND PLACEMENT OF COMPACTED ABC STONE SHALL BE INCLUDED IN THE PRICES BID FOR OTHER ITEMS. NO SEPARATE PAYMENT WILL BE MADE.
3. THE CONTRACTOR SHALL DEMOLISH AND PROPERLY DISPOSE OF ALL EXISTING CONCRETE SIDEWALK, CONCRETE CURBING, ASPHALT PAVEMENT, AND OTHER ITEMS AS SHOWN ON THE DEMOLITION PLAN. STONE CURBING AND BRICK PAVERS SHALL BE CAREFULLY REMOVED BY THE CONTRACTOR AND SALVAGED TO A LOCATION APPROVED BY THE CITY. STONE CURBING SHALL BE HAULED BY THE CONTRACTOR TO A LOCATION PROVIDED BY THE CITY. OTHER MATERIALS DEMOLISHED BY THE CONTRACTOR SHALL BE HAULED TO A LOCATION PROVIDED BY THE CITY. THE PLAN SHALL BE THE BASIS OF THE DEMOLITION. THE CONTRACTOR SHALL DEMOLISH THE ENTIRE DEPTH OF CONCRETE SIDEWALK AT THE PRICE BID PER SQUARE YARD OF CONCRETE SIDEWALK REMOVAL. THE COST OF CONCRETE AND STONE CURB DEMOLITION SHALL BE INCLUDED IN THE PRICES BID FOR OTHER ITEMS AND NO SEPARATE PAYMENT SHALL BE MADE. NO ADDITIONAL PAYMENT WILL BE MADE FOR DEPTHS OF SIDEWALK OR CURBING DEMOLITION OF OTHER ITEMS NECESSARY FOR CONSTRUCTION OR DIRECTED BY THE ENGINEER SHALL BE INCLUDED IN THE PRICES BID FOR OTHER ITEMS AND NO SEPARATE PAYMENT WILL BE MADE.
4. THE CONTRACTOR SHALL USE CARE DURING DEMOLITION AND CONSTRUCTION AND SHALL NOT DAMAGE OR DISTURB ANY , ELECTRIC PANELS, DECORATIVE TRAFFIC OR PEDESTRIAN POLES, TREES OR OTHER VEGETATION, AWNINGS, SIGNS, COLUMNS, WINDOWS, DOORS, OR THRESHOLDS.
5. THE CONTRACTOR SHALL COORDINATE REMOVAL AND REPLACEMENT OF MAILBOXES, TABLES, ETC. WITH THEIR RESPECTIVE OWNERS.
6. THE REMOVAL OF ANY ANCILLARY ITEMS SUCH AS WATER VALVES, ETC. NECESSARY TO CONSTRUCT THE PROPOSED SIDEWALK, CURB AND GUTTER, AND OTHER IMPROVEMENTS SHALL BE COORDINATED WITH THE ENGINEER. DEMOLITION OF THESE ANCILLARY ITEMS SHALL BE INCLUDED IN THE PRICES BID FOR OTHER ITEMS. NO SEPARATE PAYMENT WILL BE MADE.
7. THE CONTRACTOR SHALL FIELD VERIFY THE EXTENT OF CONCRETE SIDEWALK DEMOLITION AND REVIEW THESE LIMITS WITH THE ENGINEER PRIOR TO COMMENCEMENT OF THE DEMOLITION WORK.

634 CHERRY ST
IDA LOUISE WELLMAN &
JEFF WELLMAN
DB 1679/697
PIN: 9579-00-2139

RIGHT-OF-WAY AGREEMENT
DB 458/657
(STATE HIGHWAY COMMISSION)
SEE EXHIBIT IN
DB 1113/75

N:590100'
E:970300'

CONC WALK

GRAVEL DRIVE

EXISTING UTILITY POLE

EXISTING WATER VALVE

CHERRY ST.
PUBLIC R/W

BL CHERRY ST

JONAS ST
PUBLIC R/W

2102.5'

8' VCP

2108.84'

17+00

MATCHLINE STA 16+20

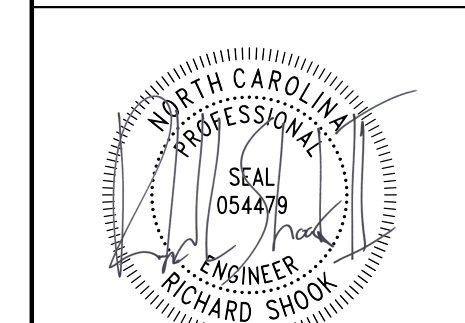
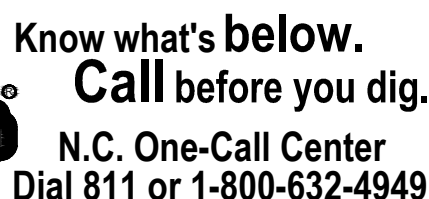
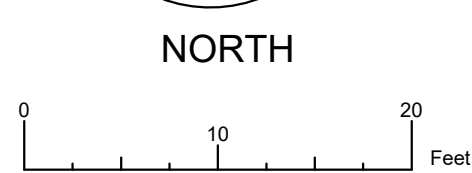

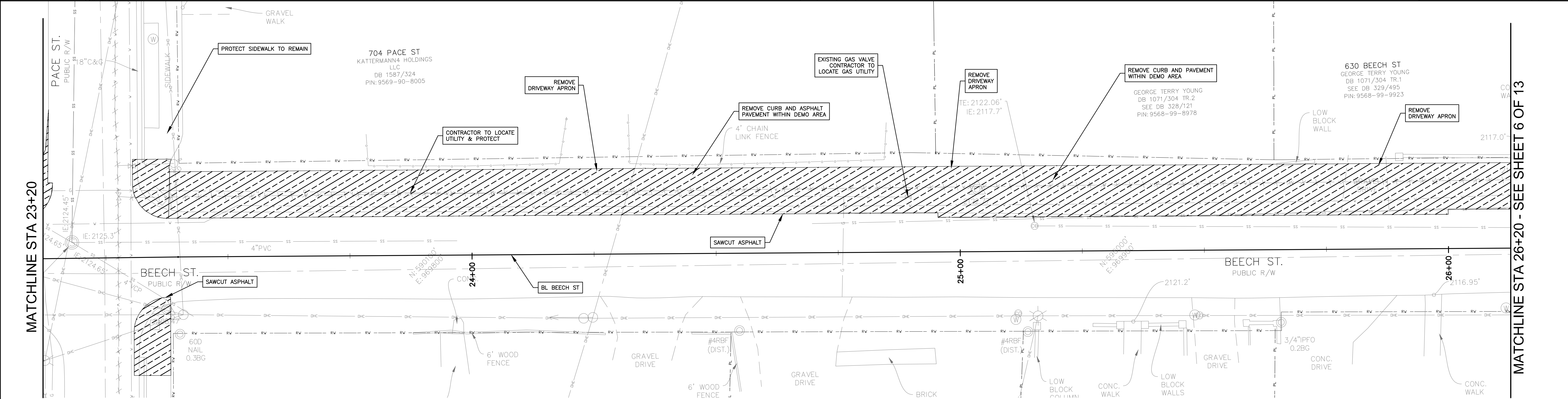
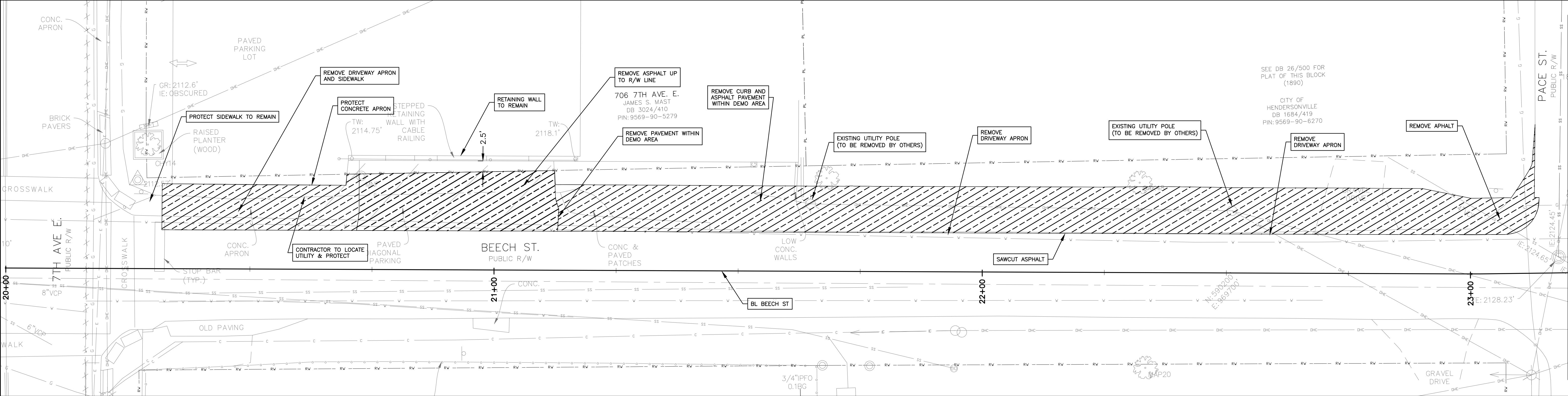

DEMOLITION NOTES:

- REPLACEMENT OF CONCRETE SIDEWALKS, CURB AND GUTTER, AND ASPHALT PAVEMENT SHALL BE COMPLETELY COORDINATED BY THE CONTRACTOR, THE RESULTING APPEARANCE OF THE PUBLIC STREETS, PARKING AREAS, CURB/GUTTER, AND SIDEWALKS SHALL BE FREE OF OBVIOUS HOLES, SCARS, CHIPPED OR DAMAGED SURFACES AND BE ARCHITECTURALLY FINISHED TO MATCH EXISTING ADJACENT SURFACES. THE CONTRACTOR SHALL CLOSELY COORDINATE THEIR DEMOLITION AND CONSTRUCTION ACTIVITIES WITH THE ENGINEER TO ENSURE THAT THE PROJECT GOES SMOOTHLY AND WITHOUT CONFLICT.
- THE CONTRACTOR SHALL PROVIDE ACCESS TO ALL PRIVATE PROPERTY, INCLUDING BUSINESSES AND RESIDENCES AT ALL TIMES DURING DEMOLITION AND CONSTRUCTION. THE CONTRACTOR SHALL PROVIDE AND MAINTAIN A SUFFICIENT LAYER OF COMPACTED ABC STONE, AS APPROVED BY THE ENGINEER, TO ALLOW ACCESS FROM THE STREETS TO THE BUILDING ENTRANCES UNTIL THE AREAS ARE READY FOR PLACEMENT OF NEW CONCRETE. THE CONTRACTOR SHALL NOTIFY THE ENGINEER AT LEAST 24 HOURS PRIOR TO ANY EXCAVATIONS OR CONSTRUCTION THAT WILL TEMPORARILY BLOCK ACCESS TO ANY BUILDING ENTRANCE FOR ANY PERIOD OF TIME. ANY TEMPORARY RESTRICTION OF BUILDING ACCESS WILL NOT BE ALLOWED UNTIL PERMISSION IS GRANTED BY THE ENGINEER. THE CONTRACTOR SHALL PROVIDE AT LEAST 24-HOURS NOTICE TO THE OWNERS AND OCCUPANTS OF ANY BUSINESSES OR RESIDENCES THAT ARE AFFECTED BY ANY TEMPORARY BLOCKING OF ACCESS. ANY COSTS ASSOCIATED WITH PROVIDING ACCESS, INCLUDING COORDINATION WITH OWNERS/OCCUPANTS, AND PLACEMENT OF COMPACTED ABC STONE SHALL BE INCLUDED IN THE PRICES BID FOR OTHER ITEMS. NO SEPARATE PAYMENT WILL BE MADE.
- THE CONTRACTOR SHALL DEMOLISH AND PROPERLY DISPOSE OF ALL EXISTING CONCRETE SIDEWALK, CONCRETE CURBING, ASPHALT PAVEMENT, AND OTHER ITEMS AS SHOWN ON THE DEMOLITION PLAN. STONE CURBING AND BRICK PAVERS SHALL BE CAREFULLY REMOVED BY THE CONTRACTOR AND SALVAGED TO A LOCATION APPROVED BY THE CITY. STONE CURBING SHALL BE HAULED BY THE CONTRACTOR TO A LOCATION PROVIDED BY THE ENGINEER. BRICK PAVERS SHALL BE REMOVED BY THE CONTRACTOR TO BE SALVAGED AND USED IN AREAS SHOWN ON THE PLAN. THE CONTRACTOR SHALL DEMOLISH THE ENTIRE DEPTH OF CONCRETE SIDEWALK AT THE PRICE BID PER SQUARE YARD OF CONCRETE SIDEWALK REMOVAL. THE COST OF CONCRETE AND STONE CURB DEMOLITION SHALL BE INCLUDED IN THE PRICES BID FOR OTHER ITEMS AND NO SEPARATE PAYMENTS SHALL BE MADE. NO ADDITIONAL PAYMENT MADE FOR DEPTHS OF SIDEWALK OR CURBING DEMOLITION OF OTHER ITEMS NECESSARY FOR CONSTRUCTION OR DIRECTED BY THE ENGINEER SHALL BE INCLUDED IN THE PRICES BID FOR OTHER ITEMS AND NO SEPARATE PAYMENT WILL BE MADE.
- THE CONTRACTOR SHALL USE CARE DURING DEMOLITION AND CONSTRUCTION AND SHALL NOT DAMAGE OR DISTURB ANY ELECTRIC PANELS, DECORATIVE TRAFFIC OR PEDESTRIAN POLES, TREES OR OTHER VEGETATION, AWNINGS, SIGNS, COLUMNS, WINDOWS, DOORS, OR THRESHOLDS.
- THE CONTRACTOR SHALL COORDINATE REMOVAL AND REPLACEMENT OF MAILBOXES, TABLES, ETC. WITH THEIR RESPECTIVE OWNERS.
- THE REMOVAL OF ANY ANCILLARY ITEMS SUCH AS WATER VALVES, ETC. NECESSARY TO CONSTRUCT THE PROPOSED SIDEWALK, CURB AND GUTTER, OR OTHER IMPROVEMENTS SHALL BE COORDINATED WITH THE ENGINEER. DEMOLITION OF THESE ANCILLARY ITEMS SHALL BE INCLUDED IN THE PRICES BID FOR OTHER ITEMS. NO SEPARATE PAYMENT WILL BE MADE.
- THE CONTRACTOR SHALL FIELD VERIFY THE EXTENT OF CONCRETE SIDEWALK DEMOLITION AND REVIEW THESE LIMITS WITH THE ENGINEER PRIOR TO COMMENCEMENT OF THE DEMOLITION WORK.

NOTE:
LOCATIONS OF EXISTING UTILITIES AS SHOWN ARE APPROXIMATE. EXACT LOCATIONS ARE TO BE VERIFIED IN THE FIELD BY THE CONTRACTOR.

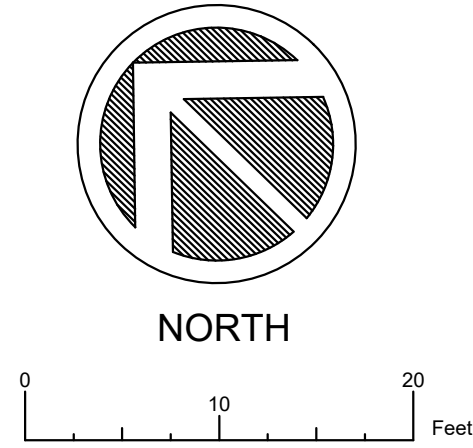

CITY OF HENDERSONVILLE, NC
"The City of Four Seasons"
City of Hendersonville Engineering Department
305 Williams Street
Hendersonville, NC 28922
(828) 697-3000 (office)
(828) 697-3006 (fax)
www.cityofhendersonville.org

NO.	DATE	ISSUED FOR BID	BY
1	02/21/2025	RLS	

CHERRY & BEECH SIDEWALK IMPROVEMENTS

DEMOLITION PLANS



JMB RLS CC 2025.02.21
Dwn. Dsgn. Chkd. YYYY.MM.DD
Project No.: 18017
Revision: 01
Sheet: 5 of 13
Drawing No. C5

MATCHLINE STA 26+20 - SEE SHEET 5 OF 13

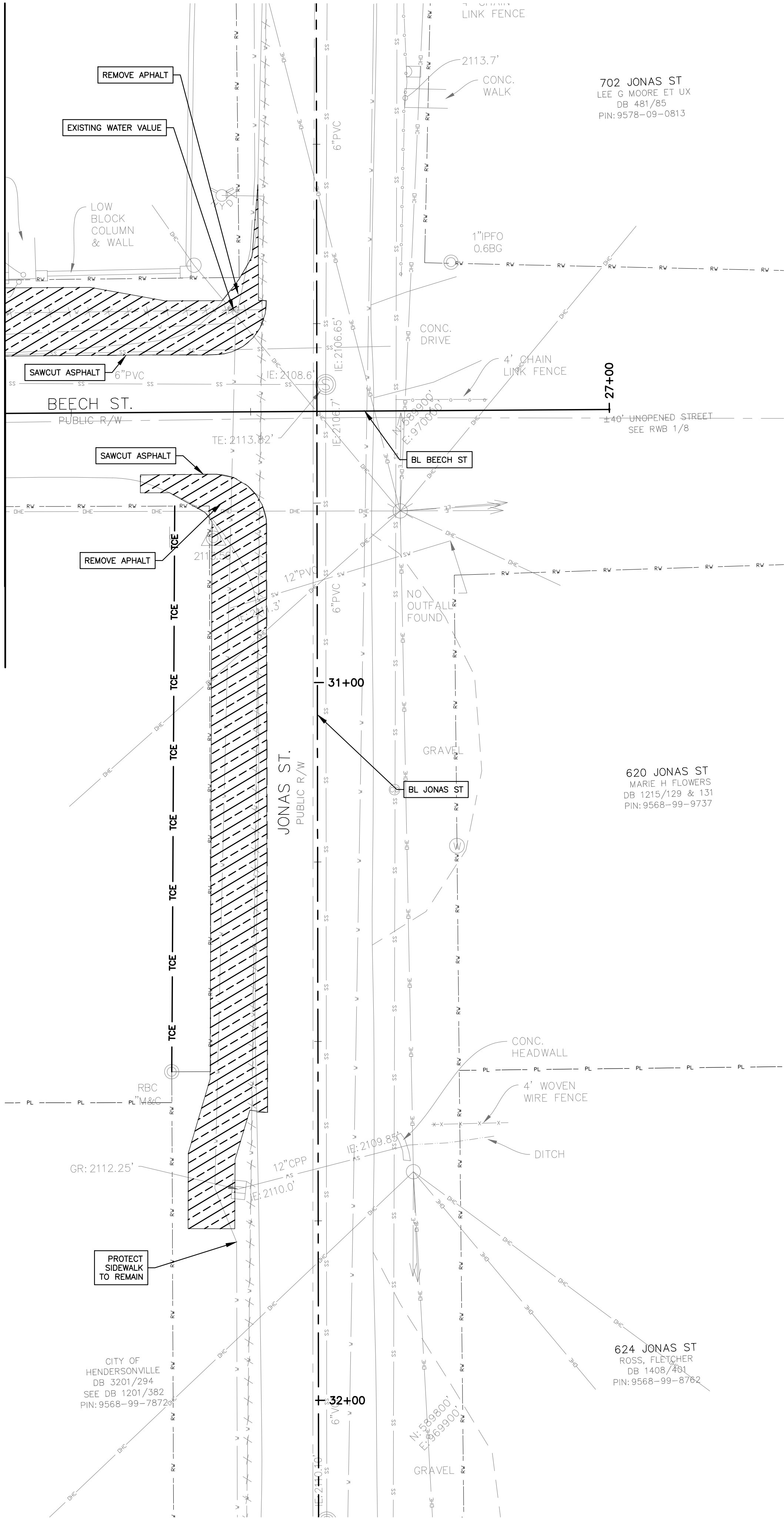

DEMOLITION NOTES:

1. REPLACEMENT OF CONCRETE SIDEWALKS, CURB AND GUTTER, AND ASPHALT PAVEMENT SHALL BE COMPLETELY COORDINATED BY THE CONTRACTOR, THE RESULTING APPEARANCE OF THE PUBLIC STREETS, PARKING AREAS, CURB/GUTTER, AND SIDEWALKS SHALL BE FREE OF OBVIOUS HOLES, SCARS, CHIPPED OR DAMAGED SURFACES AND BE ARCHITECTURALLY FINISHED TO MATCH EXISTING ADJACENT SURFACES. THE CONTRACTOR SHALL CLOSELY COORDINATE THEIR DEMOLITION AND CONSTRUCTION ACTIVITIES WITH THE ENGINEER TO ENSURE THAT THE PROJECT GOES SMOOTHLY AND WITHOUT CONFLICT.
2. THE CONTRACTOR SHALL PROVIDE ACCESS TO ALL PRIVATE PROPERTY, INCLUDING BUSINESSES AND RESIDENCES AT ALL TIMES DURING DEMOLITION AND CONSTRUCTION. THE CONTRACTOR SHALL PROVIDE AND MAINTAIN A SUFFICIENT LAYER OF COMPACTED ABC STONE, AS APPROVED BY THE ENGINEER, TO ALLOW ACCESS FROM THE STREETS TO THE BUILDING ENTRANCES UNTIL THE AREAS ARE READY FOR PLACEMENT OF NEW CONCRETE. THE CONTRACTOR SHALL NOTIFY THE ENGINEER AT LEAST 24 HOURS PRIOR TO ANY EXCAVATIONS OR CONSTRUCTION THAT WILL TEMPORARILY BLOCK ACCESS TO ANY BUILDING ENTRANCE FOR ANY PERIOD OF TIME. ANY TEMPORARY RESTRICTION OF BUILDING ACCESS WILL NOT BE ALLOWED UNTIL PERMISSION IS GRANTED BY THE ENGINEER. THE CONTRACTOR SHALL PROVIDE AT LEAST 24-HOURS NOTICE TO THE OWNERS AND OCCUPANTS OF ANY BUSINESSES OR RESIDENCES THAT ARE AFFECTED BY ANY TEMPORARY BLOCK OF ACCESS. ANY COSTS ASSOCIATED WITH PROVIDING ACCESS, INCLUDING COORDINATION WITH OWNERS/OCCUPANTS, AND PLACEMENT OF COMPACTED ABC STONE SHALL BE INCLUDED IN THE PRICES BID FOR OTHER ITEMS. NO SEPARATE PAYMENT WILL BE MADE.
3. THE CONTRACTOR SHALL DEMOLISH AND PROPERLY DISPOSE OF ALL EXISTING CONCRETE SIDEWALK, CONCRETE CURBING, ASPHALT PAVEMENT, AND OTHER ITEMS AS SHOWN ON THE DEMOLITION PLAN. STONE CURBING AND BRICK PAVERS SHALL BE CAREFULLY REMOVED BY THE CONTRACTOR AND SALVAGED TO A LOCATION APPROVED BY THE CITY. STONE CURBING SHALL BE HAULED BY THE CONTRACTOR TO A LOCATION PROVIDED BY THE ENGINEER. BRICK PAVERS SHALL BE REMOVED BY THE CONTRACTOR TO BE SALVAGED AND USED IN AREAS SHOWN ON THE PLAN. THE CONTRACTOR SHALL DEMOLISH THE ENTIRE DEPTH OF CONCRETE SIDEWALK AT THE PRICE BID PER SQUARE YARD OF CONCRETE SIDEWALK REMOVAL. THE COST OF CONCRETE AND STONE CURB DEMOLITION SHALL BE INCLUDED IN THE PRICES BID FOR OTHER ITEMS AND NO SEPARATE PAYMENTS SHALL BE MADE. NO ADDITIONAL PAYMENT MADE FOR DEPTHS OF SIDEWALK OR CURBING. DEMOLITION OF OTHER ITEMS NECESSARY FOR CONSTRUCTION OR DIRECTED BY THE ENGINEER SHALL BE INCLUDED IN THE PRICES BID FOR OTHER ITEMS AND NO SEPARATE PAYMENT WILL BE MADE.
4. THE CONTRACTOR SHALL USE CARE DURING DEMOLITION AND CONSTRUCTION AND SHALL NOT DAMAGE OR DISTURB ANY , ELECTRIC PANELS, DECORATIVE TRAFFIC OR PEDESTRIAN POLES, TREES OR OTHER VEGETATION, AWNINGS, SIGNS, COLUMNS, WINDOWS, DOORS, OR THRESHOLDS.
5. THE CONTRACTOR SHALL COORDINATE REMOVAL AND REPLACEMENT OF MAILBOXES, TABLES, ETC. WITH THEIR RESPECTIVE OWNERS.
6. THE REMOVAL OF ANY ANCILLARY ITEMS SUCH AS WATER VALVES, ETC. NECESSARY TO CONSTRUCT THE PROPOSED SIDEWALK, CURB AND GUTTER, OR OTHER IMPROVEMENTS SHALL BE COORDINATED WITH THE ENGINEER. DEMOLITION OF THESE ANCILLARY ITEMS SHALL BE INCLUDED IN THE PRICES BID FOR OTHER ITEMS. NO SEPARATE PAYMENT WILL BE MADE.
7. THE CONTRACTOR SHALL FIELD VERIFY THE EXTENT OF CONCRETE SIDEWALK DEMOLITION AND REVIEW THESE LIMITS WITH THE ENGINEER PRIOR TO COMMENCEMENT OF THE DEMOLITION WORK.

NOTE:

LOCATIONS OF EXISTING UTILITIES AS SHOWN ARE APPROXIMATE. EXACT LOCATIONS ARE TO BE VERIFIED IN THE FIELD BY THE CONTRACTOR.



CITY OF HENDERSONVILLE, NC
"The City of Four Seasons"

City of Hendersonville Engineering Department
305 Williams Street
Hendersonville, NC 28922
(828) 697-3000 (office)
(828) 697-3086 (fax)
www.cityofhendersonville.org

NO.	DATE	DESCRIPTION	BY
1	02/21/2025	ISSUED FOR BID	RLS

CHERRY & BEECH SIDEWALK IMPROVEMENTS

DEMOLITION PLANS

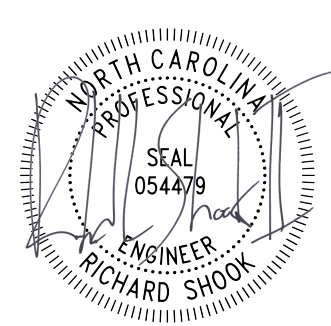

JMB	RLS	CC	2025.02.21
Dwn.	Dsgn.	Chkd.	YYYY.MM.DD
Project No.: 18017			
Revision: 01			
Sheet: 6 of 13			
Drawing No. C6			

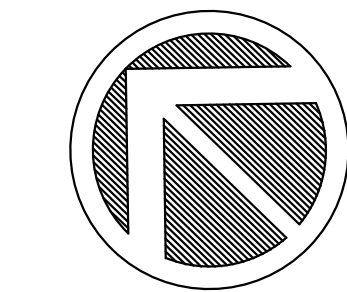

0 10 20 Feet

811 Know what's below.
Call before you dig.
N.C. One-Call Center
Dial 811 or 1-800-632-4949

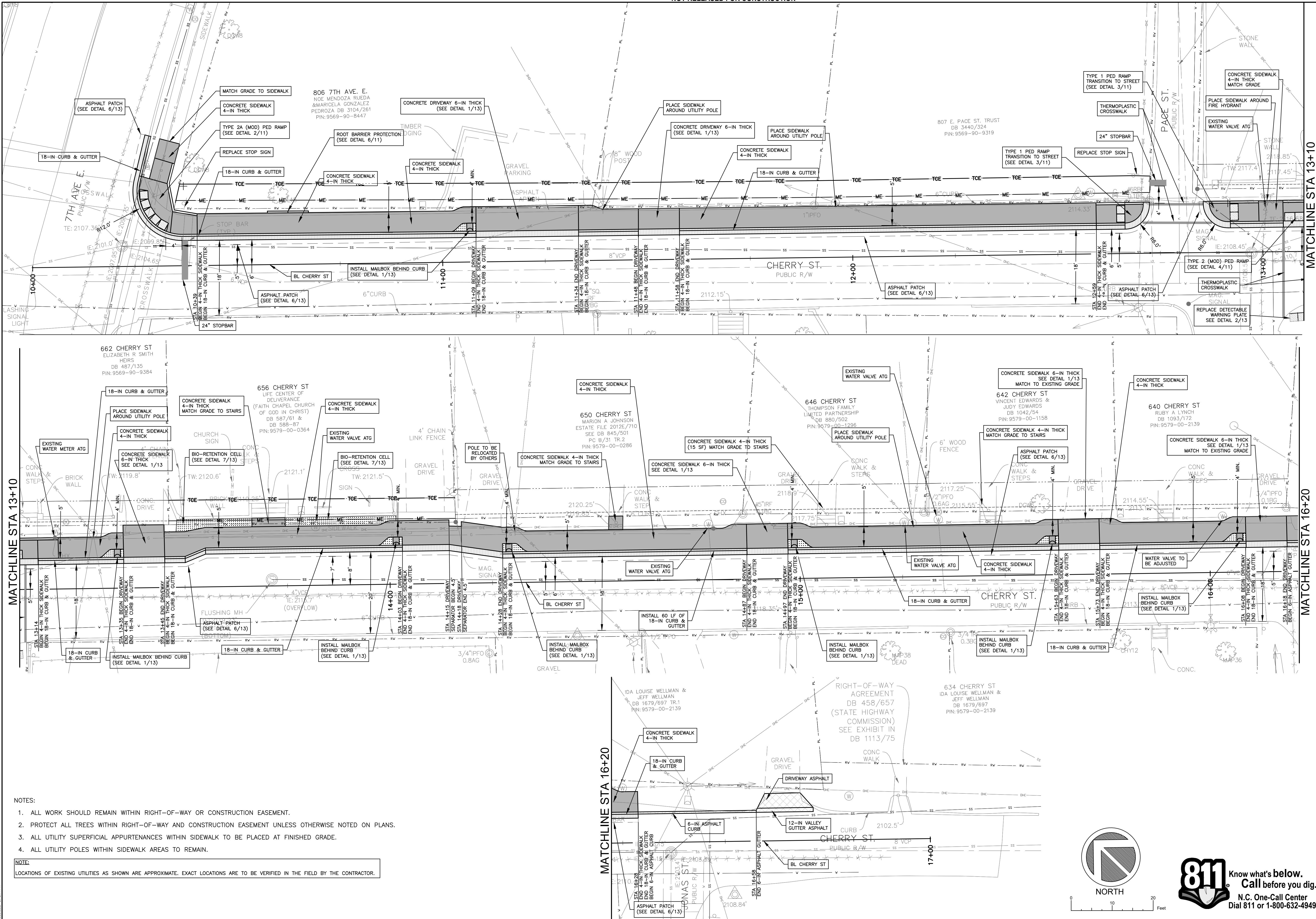

- NOTES:
1. ALL WORK SHOULD REMAIN WITHIN RIGHT-OF-WAY OR CONSTRUCTION EASEMENT.
 2. PROTECT ALL TREES WITHIN RIGHT-OF-WAY AND CONSTRUCTION EASEMENT UNLESS OTHERWISE NOTED ON PLANS.
 3. ALL UTILITY SUPERFICIAL APPURTENANCES WITHIN SIDEWALK TO BE PLACED AT FINISHED GRADE.
 4. ALL UTILITY POLES WITHIN SIDEWALK AREAS TO REMAIN.

NOTE:
LOCATIONS OF EXISTING UTILITIES AS SHOWN ARE APPROXIMATE. EXACT LOCATIONS ARE TO BE VERIFIED IN THE FIELD BY THE CONTRACTOR.



CITY OF HENDERSONVILLE, NC
"The City of Four Seasons"

City of Hendersonville Engineering Department
305 Williams Street
Hendersonville, NC 28792
(828) 697-3000 (office)
(828) 697-3066 (fax)
www.cityofhendersonville.org

CHERRY & BEECH SIDEWALK IMPROVEMENTS

PLAN



JMB RLS CC 2025.02.21
Dwn. Dsgn. Chkd. YYYY.MM.DD
Project No.: 18017
Revision: 01
Sheet: 7 of 13
Drawing No.

C7

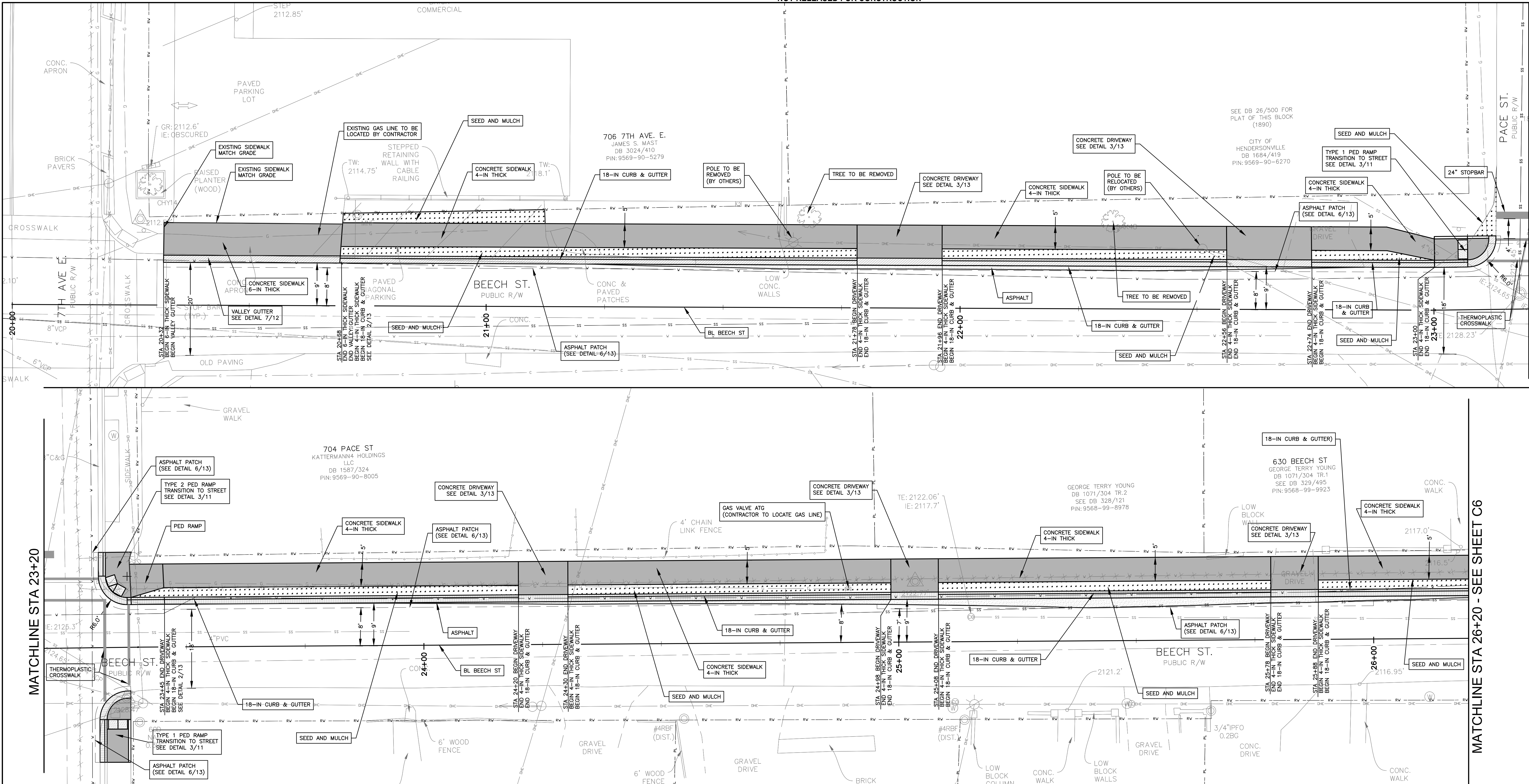

MATCHLINE STA 23+20

MATCHLINE STA 26+20 - SEE SHEET C6

- NOTES:
1. REMOVE EXISTING ASPHALT AND CURB WITHIN NEW SIDEWALK AND CROSSWALK AREAS.
 2. ALL WORK SHOULD REMAIN WITHIN RIGHT-OF-WAY OR CONSTRUCTION ESMT.
 3. PROTECT ALL TREES WITHIN RIGHT-OF-WAY AND CONSTRUCTION ESMT UNLESS OTHERWISE NOTED ON PLANS.
 4. ALL UTILITY SUPERFICIAL APPURTENANCES WITHIN SIDEWALK TO BE PLACED AT FINISHED GRADE.
 5. ALL UTILITY POLES WITHIN SIDEWALK AREAS TO REMAIN.

NOTE:
LOCATIONS OF EXISTING UTILITIES AS SHOWN ARE APPROXIMATE. EXACT LOCATIONS ARE TO BE VERIFIED IN THE FIELD BY THE CONTRACTOR.



CITY OF HENDERSONVILLE, NC
"The City of Four Seasons"

City of Hendersonville Engineering Department
305 Williams Street
Hendersonville, NC 28792
(828) 697-3000 (office)
(828) 697-3066 (fax)
www.cityofhendersonville.org

CHERRY & BEECH SIDEWALK IMPROVEMENTS

PLAN

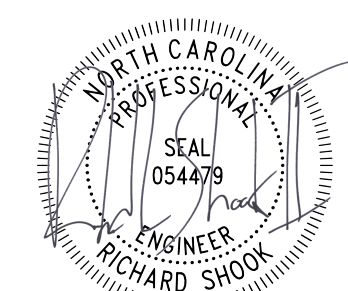

JMB RLS CC 2025.02.21
Dwn. Dsgn. Chkd. YYYY.MM.DD
Project No.: 18017
Revision: 01
Sheet: 8 of 13
Drawing No.

C8

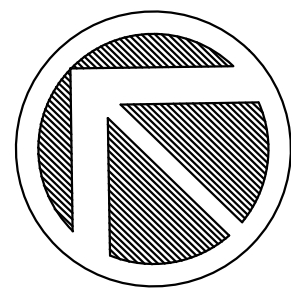

N.C. One-Call Center
Dial 811 or 1-800-632-4949

City of Hendersonville Engineering Department
305 Williams Street
Hendersonville, NC 28792
(828) 697-3000 (office)
(828) 697-3066 (fax)
www.cityofhendersonville.org

1	02/21/2025	ISSUED FOR BID	R/S	BY

PLAN

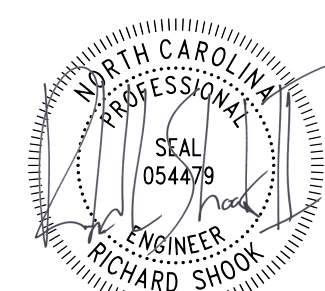

Drawing No.

C9

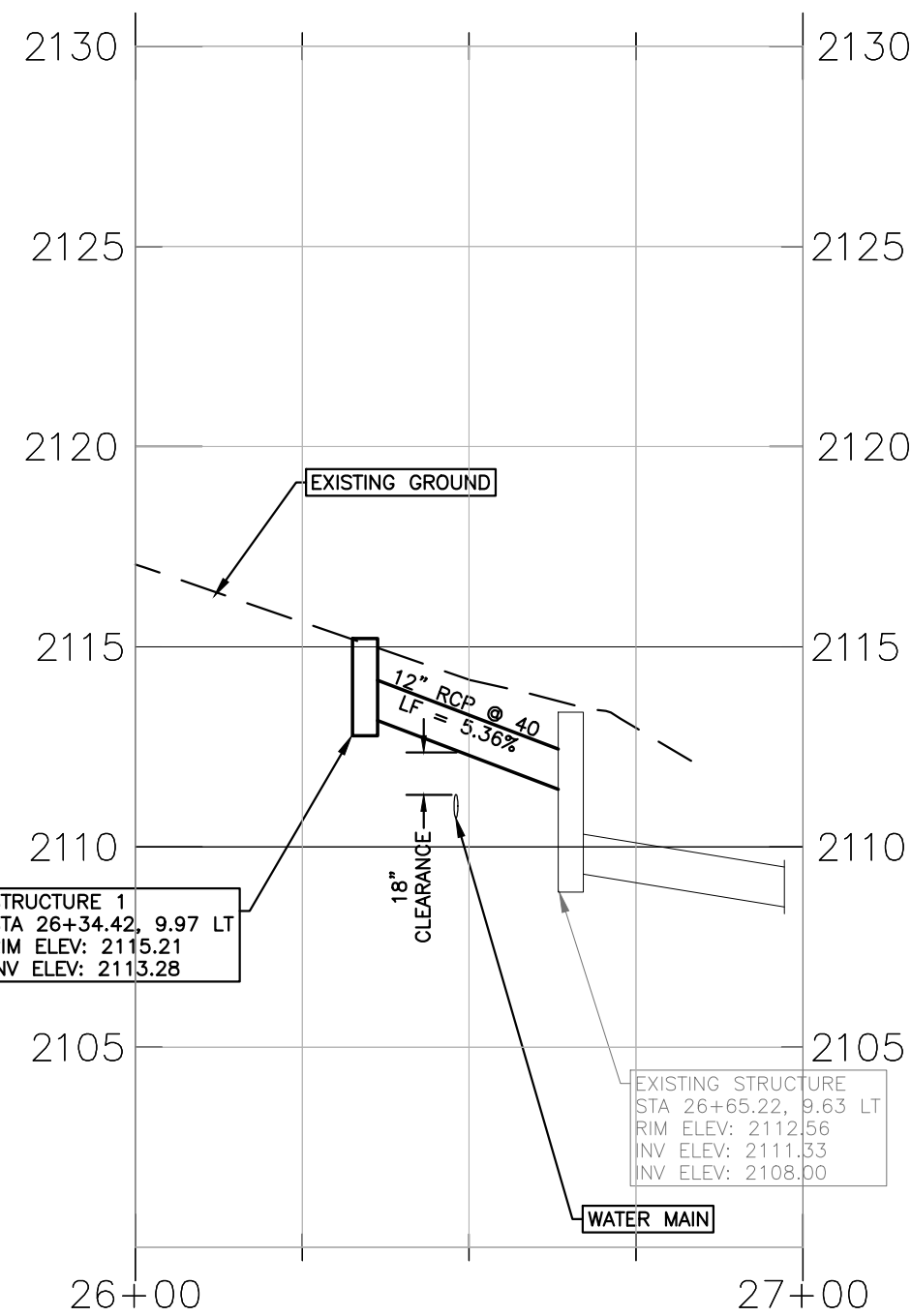

BL Beech Street
STA 26+00 TO STA 27+00

- NOTES:
1. REMOVE EXISTING ASPHALT AND CURB WITHIN NEW SIDEWALK AND CROSSWALK AREAS.
 2. ALL WORK SHOULD REMAIN WITHIN RIGHT-OF-WAY OR CONSTRUCTION ESMT.
 3. PROTECT ALL TREES WITHIN RIGHT-OF-WAY AND CONSTRUCTION ESMT UNLESS OTHERWISE NOTED ON PLANS.
 4. ALL UTILITY SUPERFICIAL APPURTENANCES WITHIN SIDEWALK TO BE PLACED AT FINISHED GRADE.
 5. ALL UTILITY POLES WITHIN SIDEWALK AREAS TO REMAIN.

NOTE:
LOCATIONS OF EXISTING UTILITIES AS SHOWN ARE APPROXIMATE. EXACT LOCATIONS ARE TO BE VERIFIED IN THE FIELD BY THE CONTRACTOR.

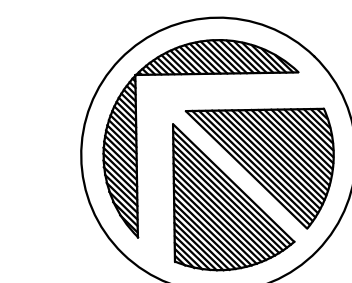

NORTH

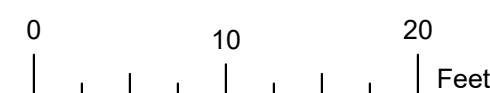

Know what's **below**.
 ☛ **Call** before you dig.
 N.C. One-Call Center
 Dial 811 or 1-800-632-4949

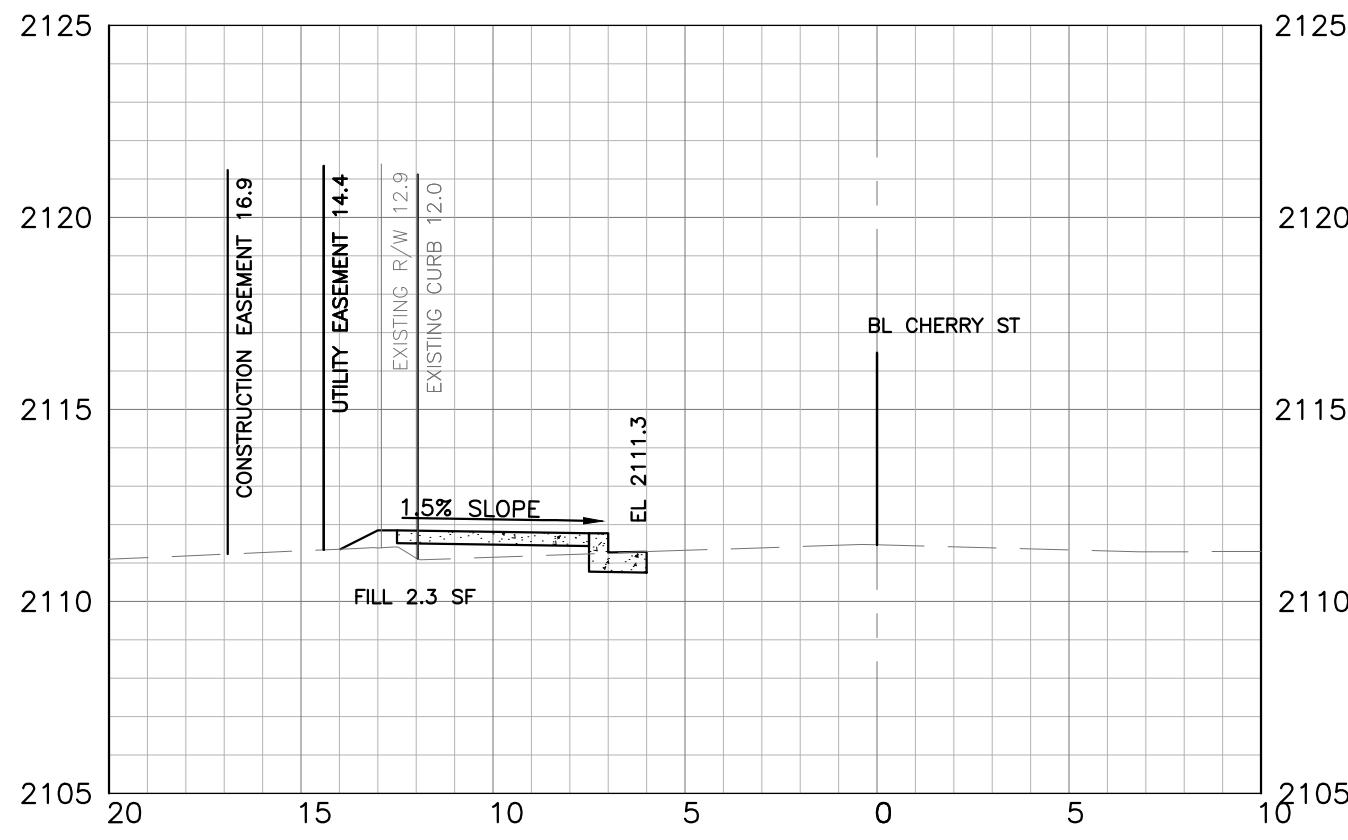

STA. 11+50
BL EL 2111.5

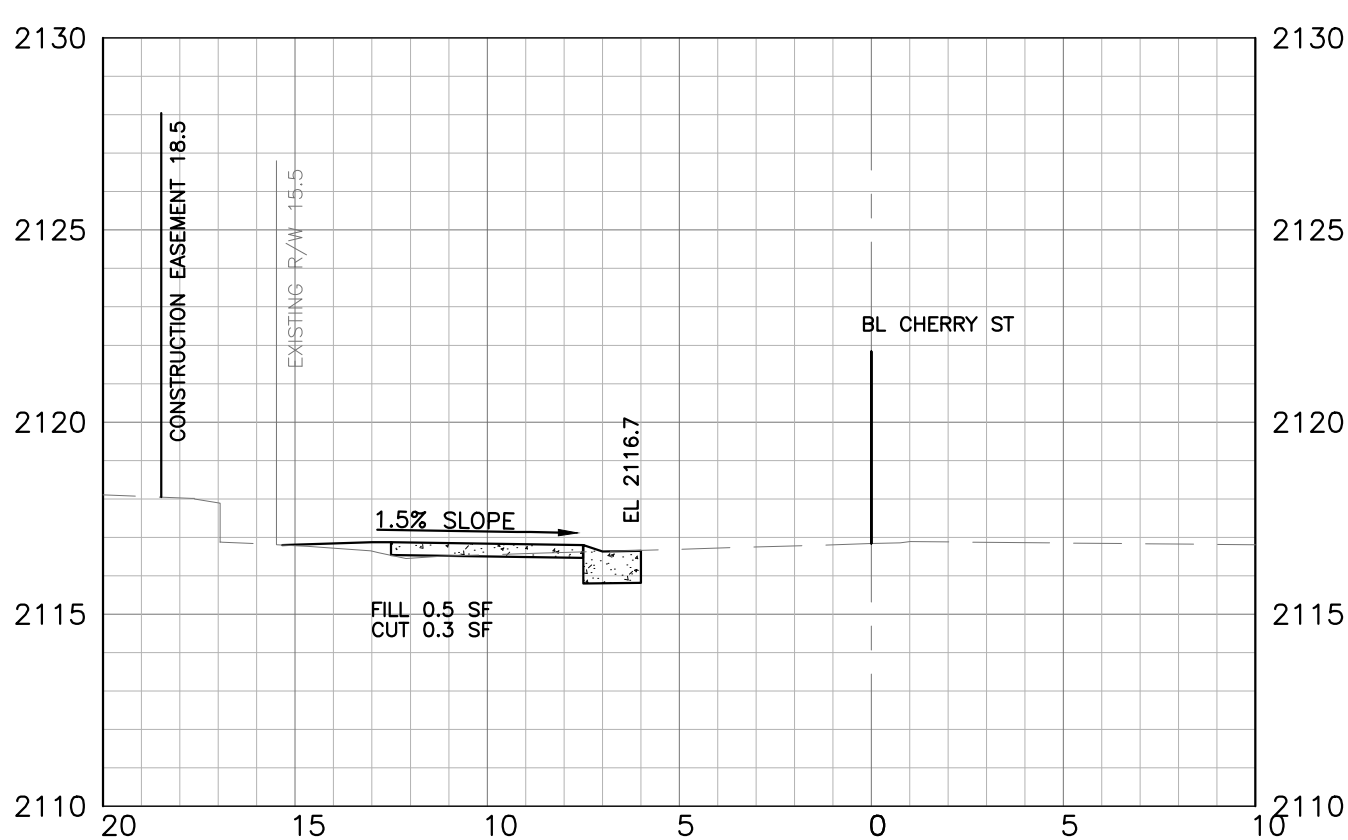

STA. 13+00
BL EL 2116.8

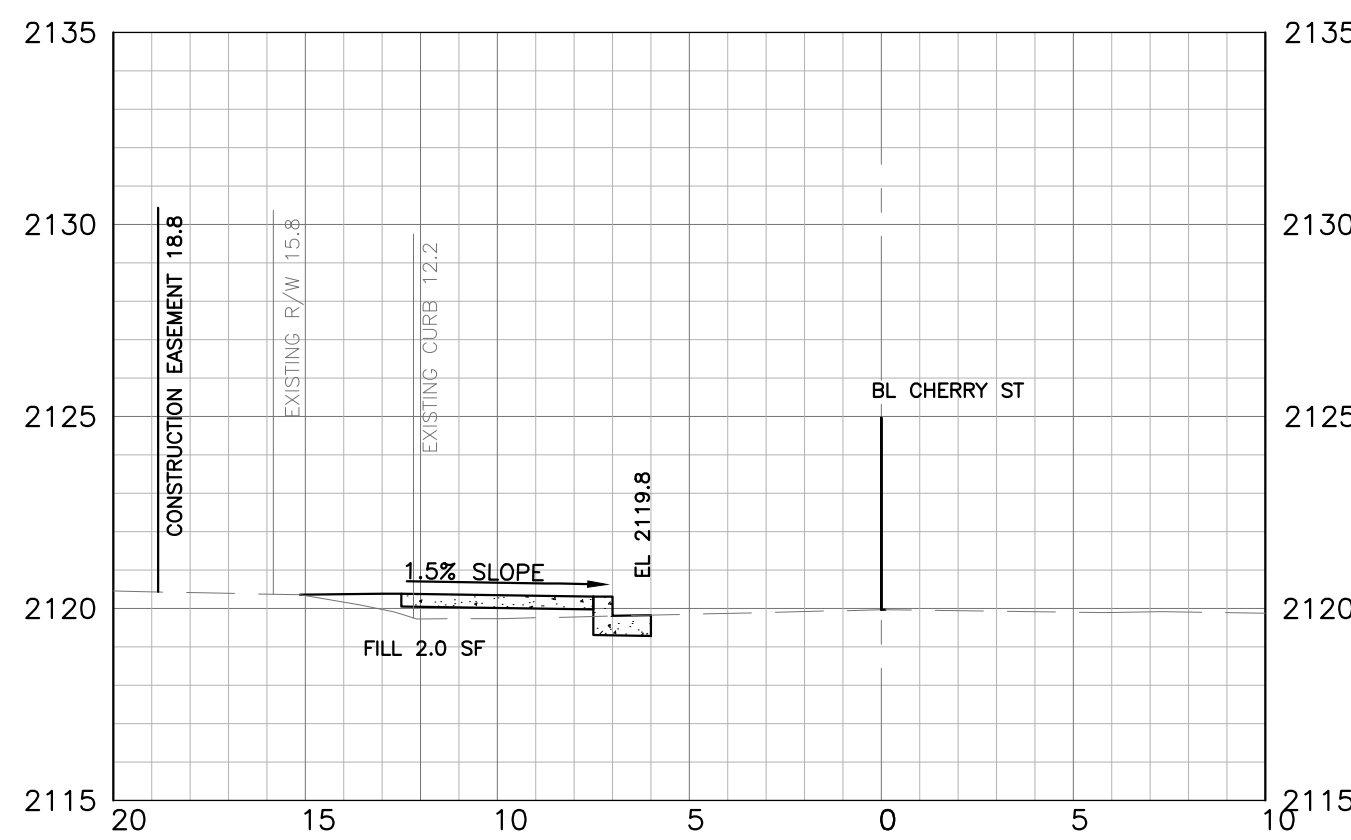

STA. 14+50
BL EL 2120.0

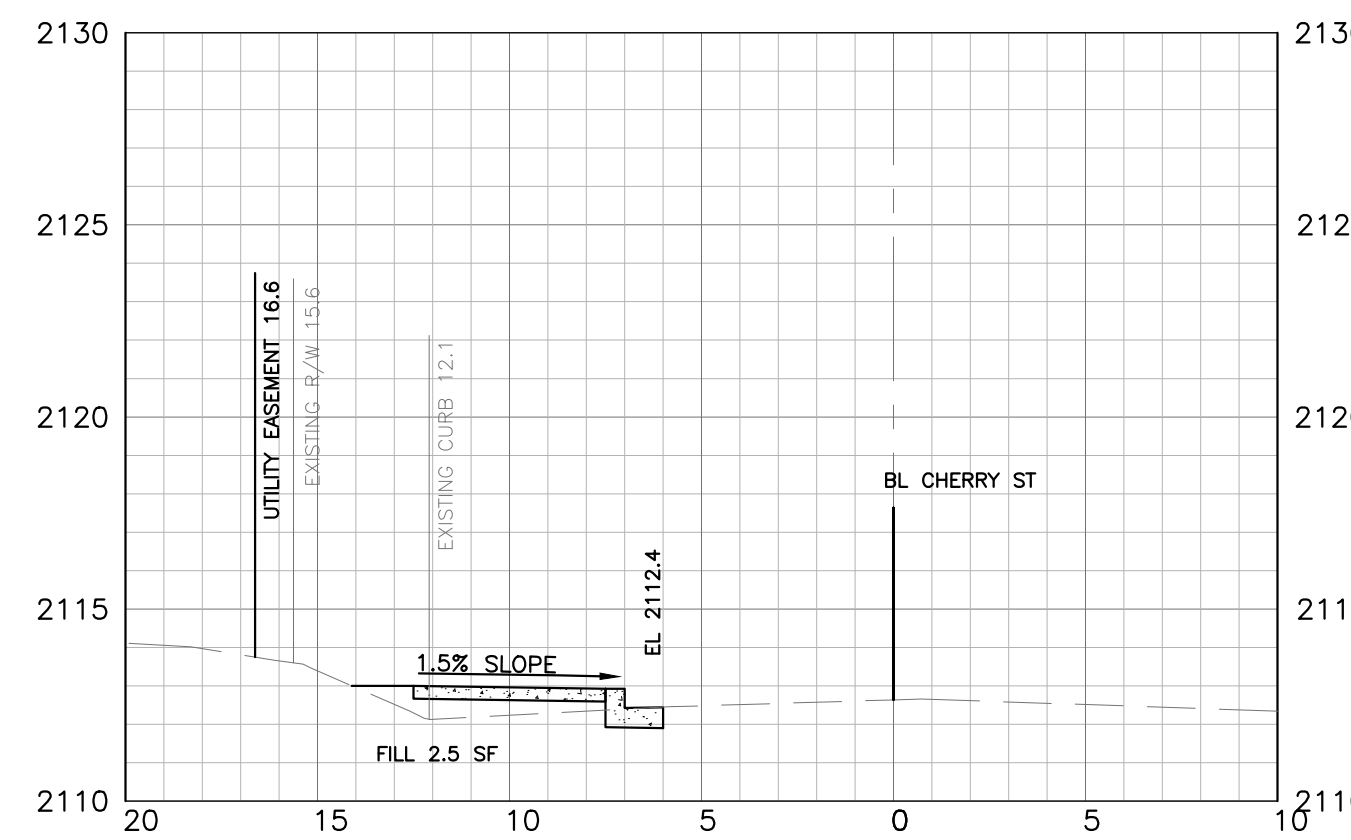

STA. 16+00
BL EL 2112.6

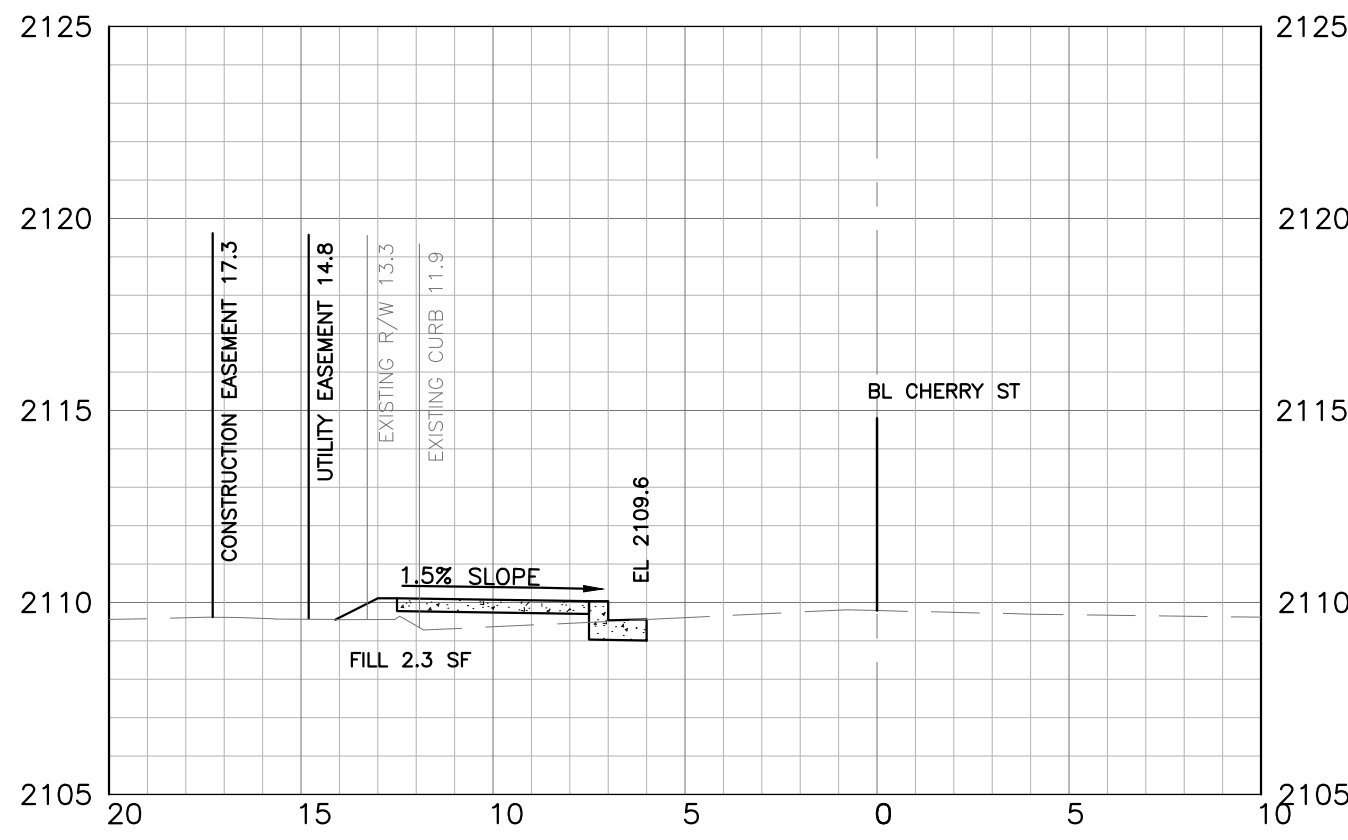

STA. 11+00
BL EL 2109.8

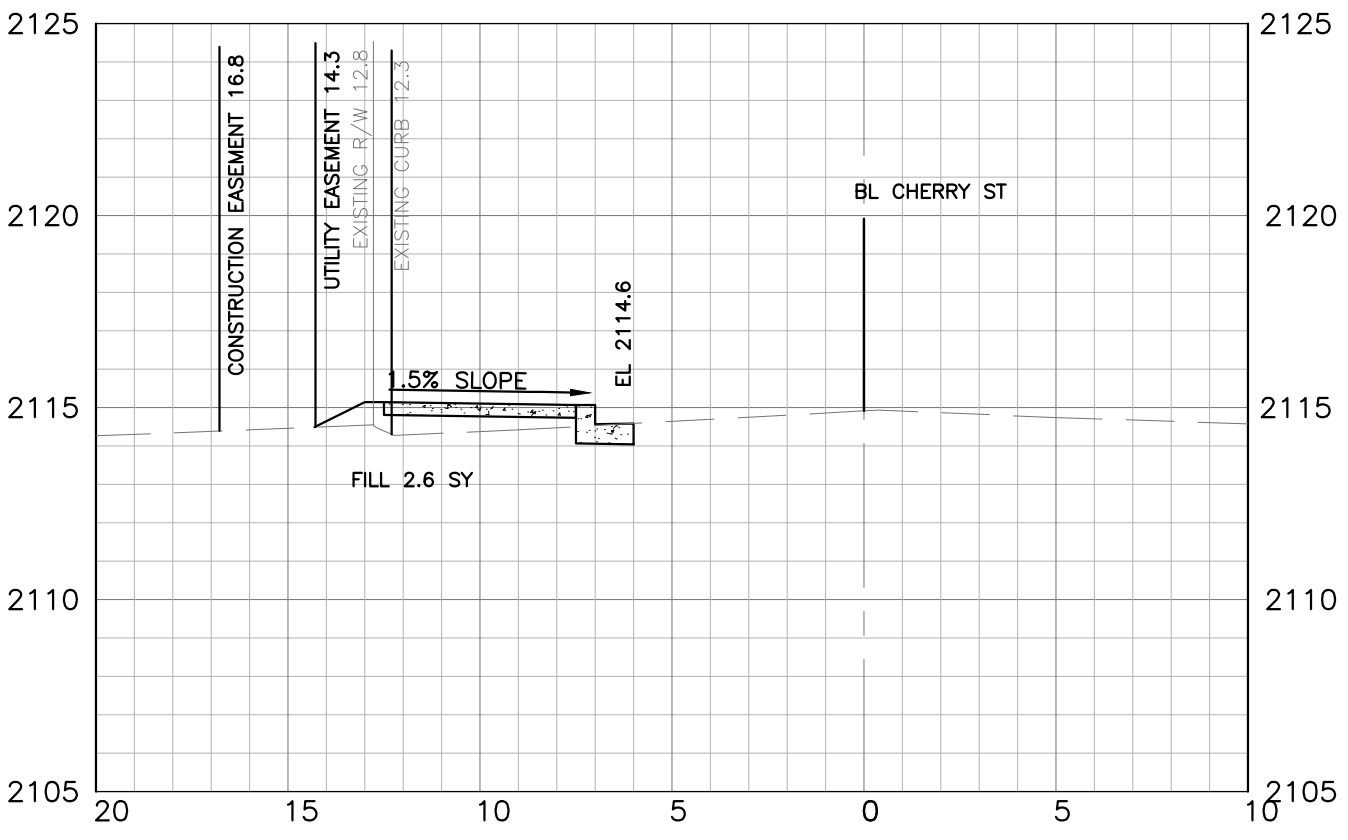

STA. 12+50
BL EL 2114.9

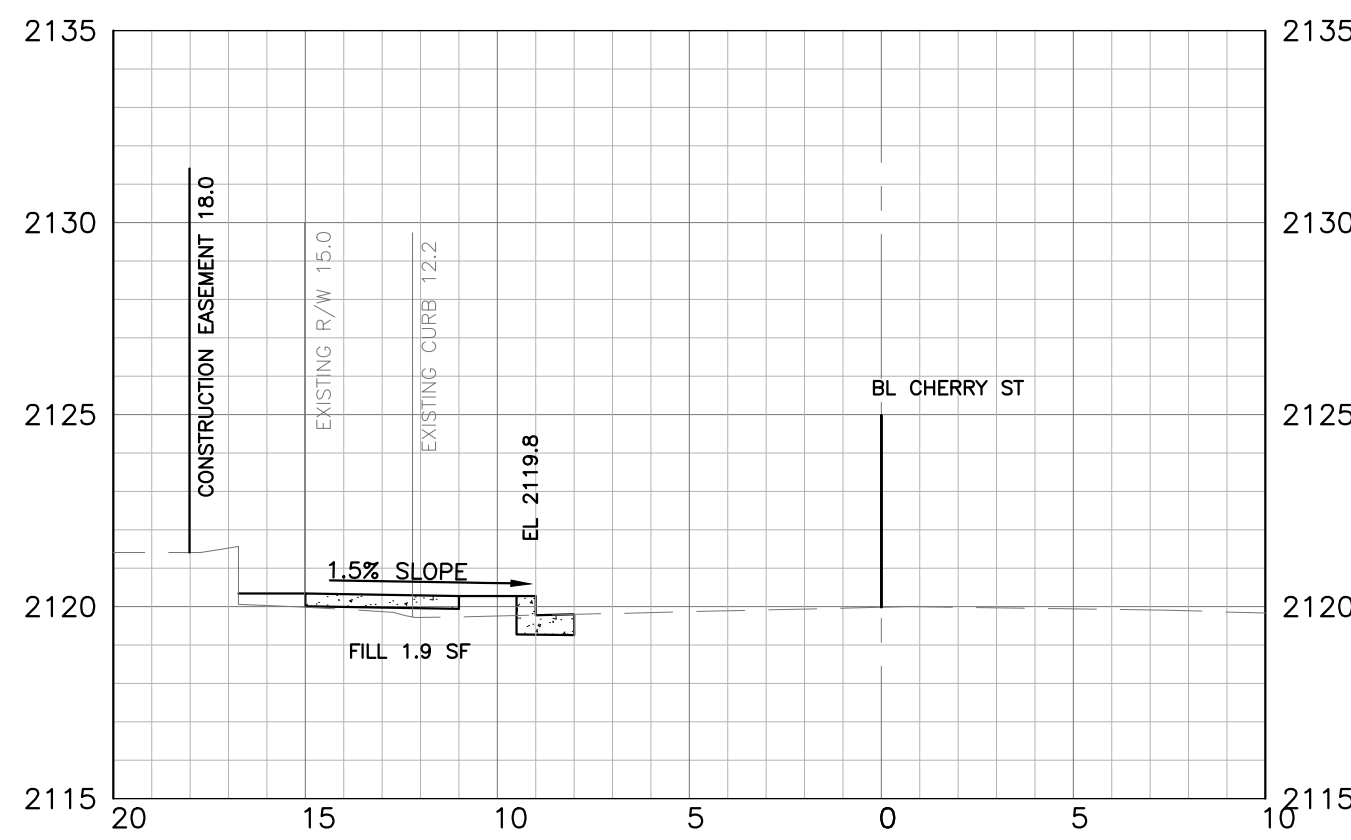

STA. 14+00
BL EL 2120.0

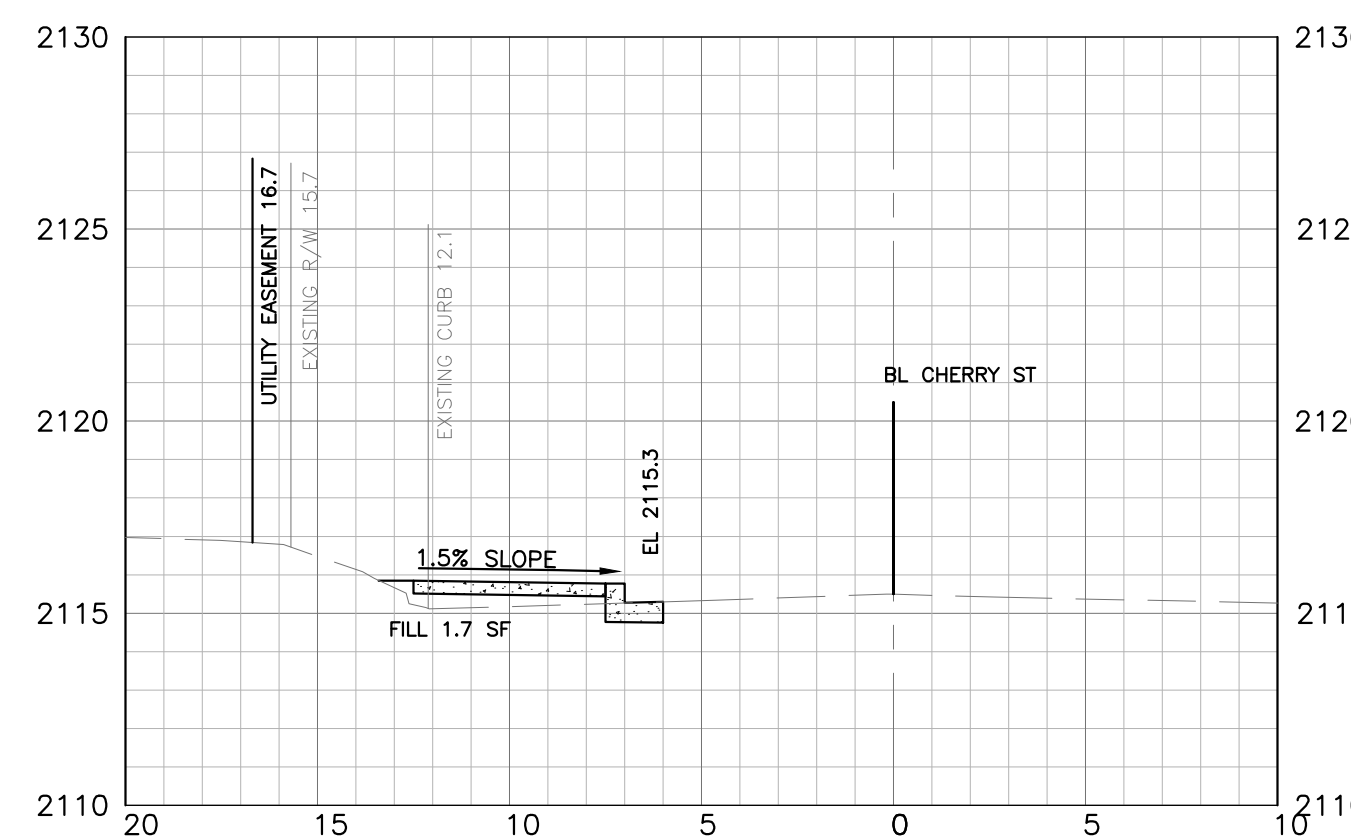

STA. 15+50
BL EL 2115.5

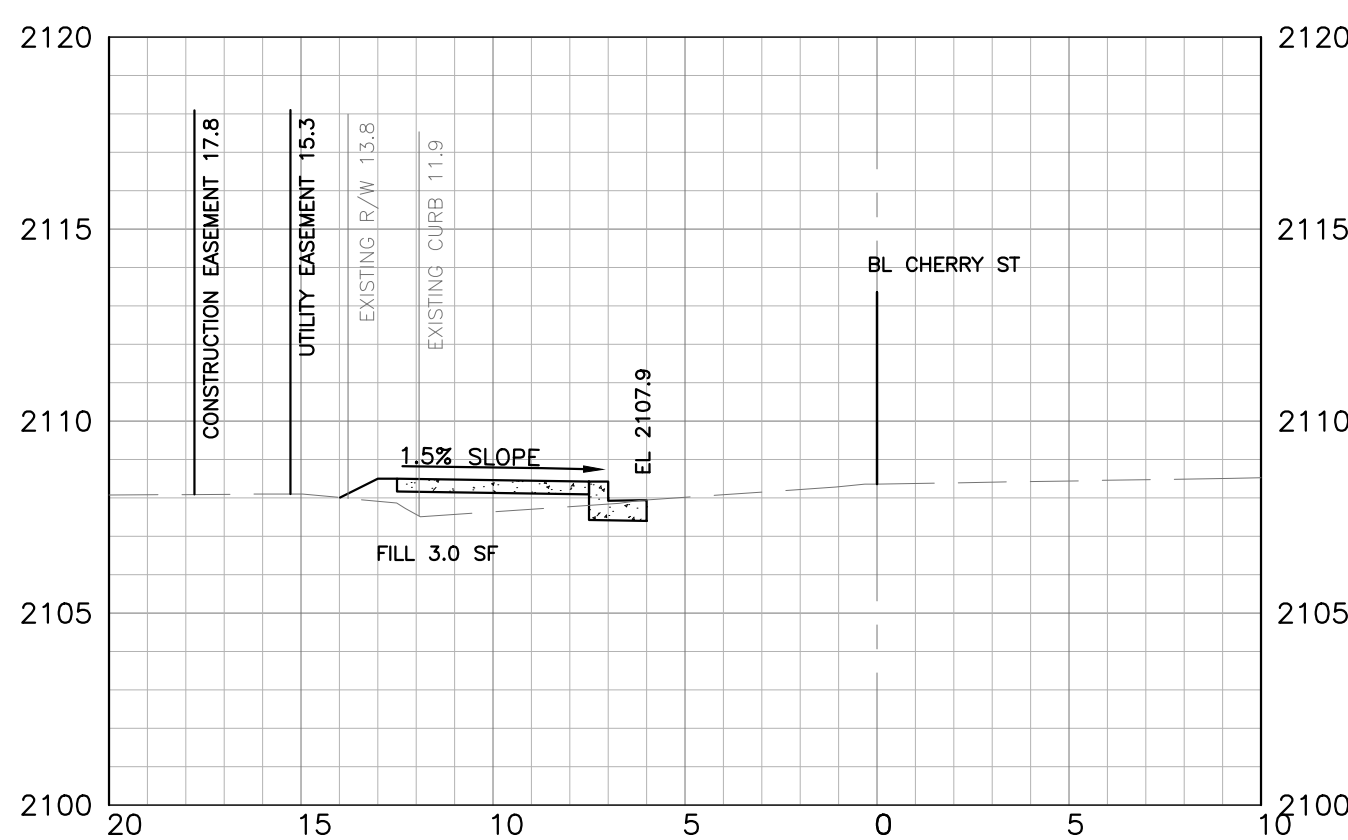

STA. 10+50
BL EL 2108.4

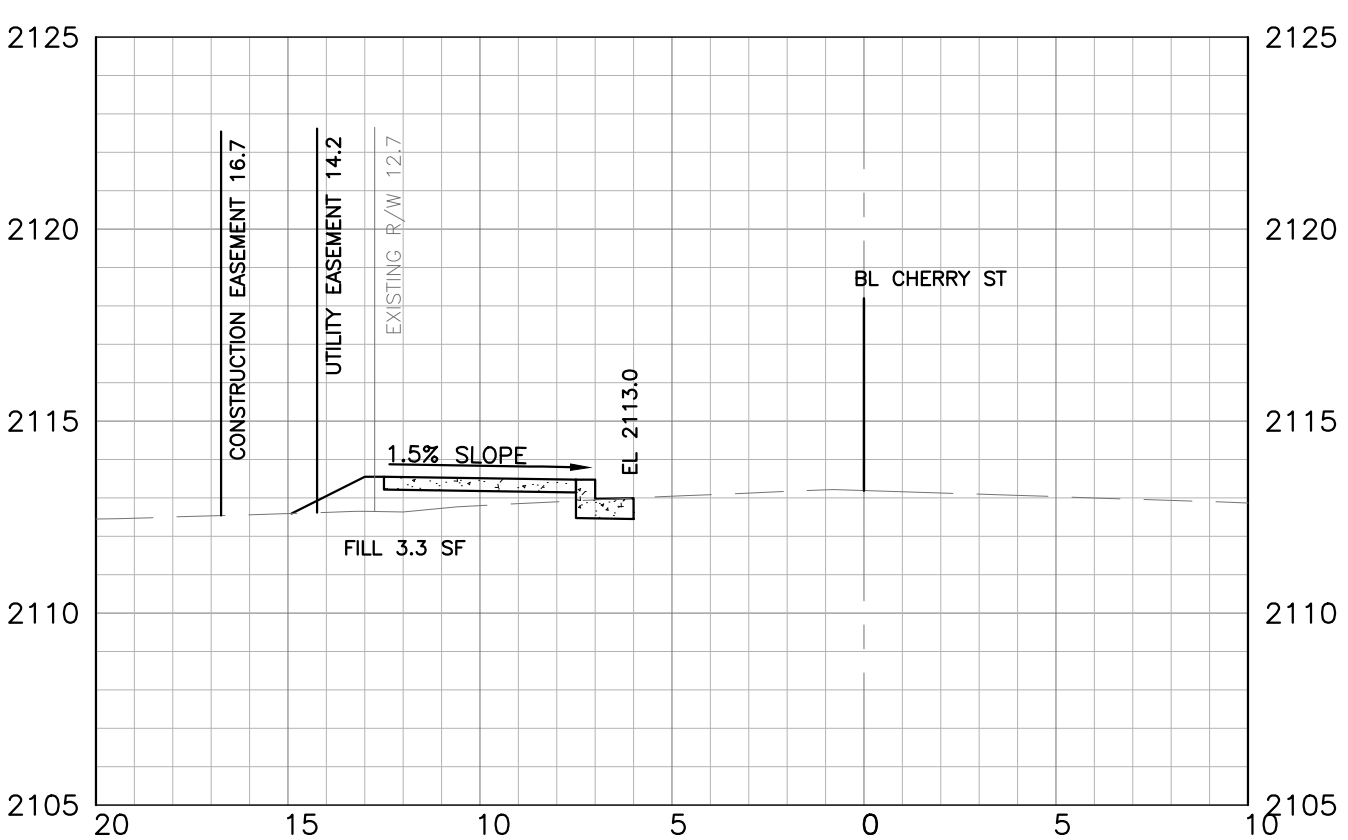

STA. 12+00
BL EL 2113.2

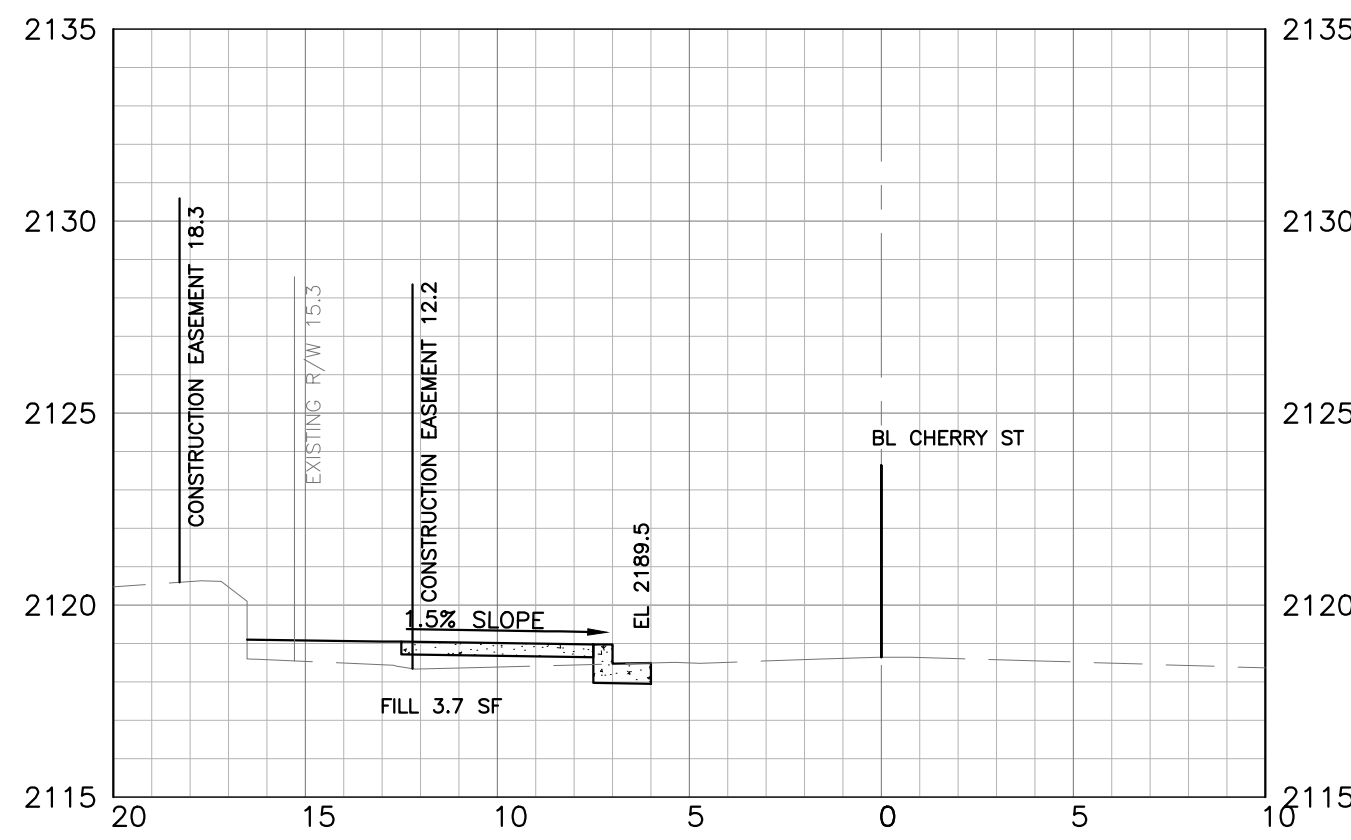

STA. 13+50
BL EL 2118.6

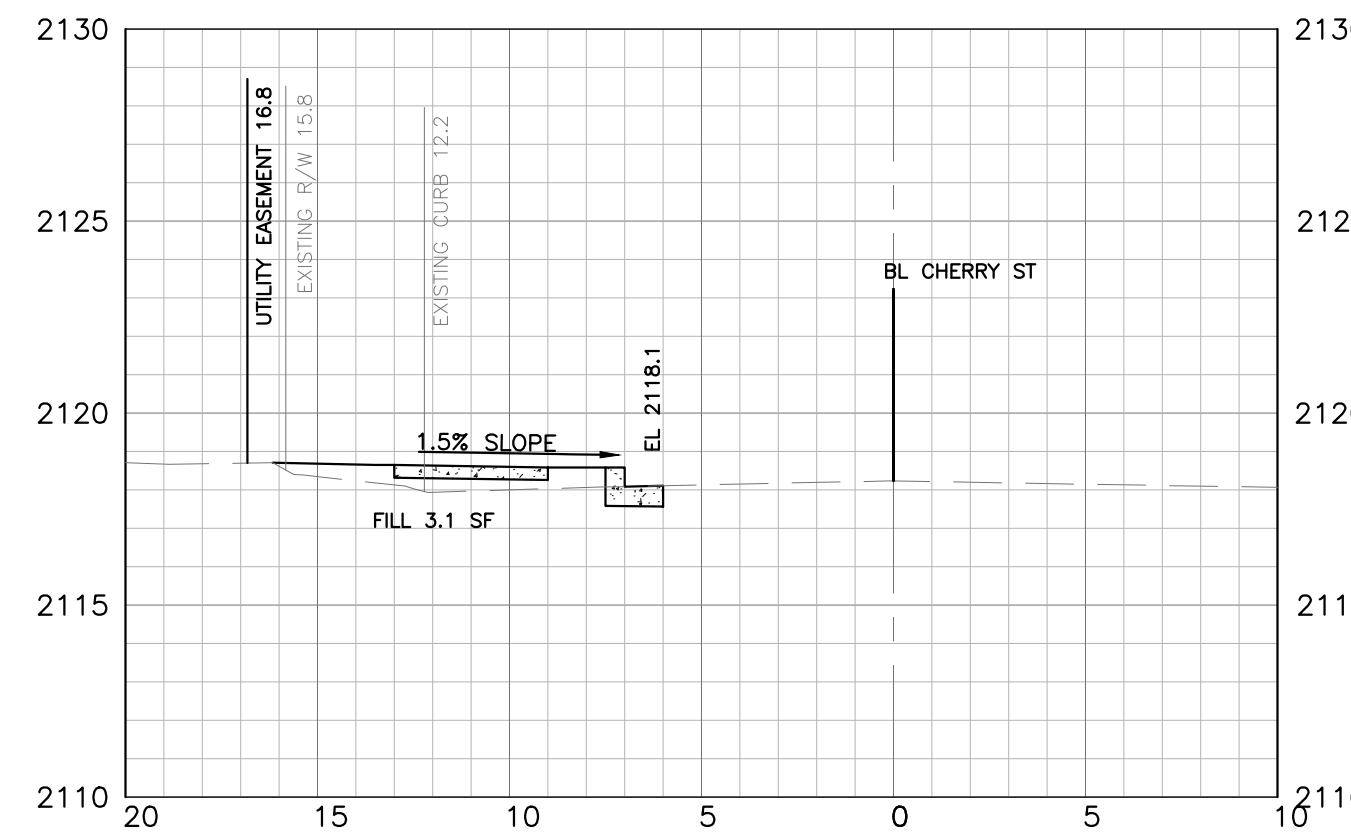

STA. 15+00
BL EL 2118.2



CITY OF HENDERSONVILLE, NC
"The City of Four Seasons"

City of Hendersonville Engineering Department
305 Williams Street
Hendersonville, NC 28792
(828) 697-3000 (office)
(828) 697-3066 (fax)
www.cityofhendersonville.org

CHERRY & BEECH SIDEWALK IMPROVEMENTS

CROSS SECTIONS

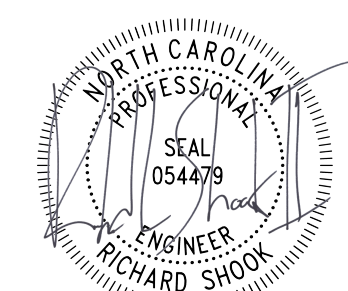

AGR RLS CC 2025.02.21
Dwn. Dsgn. Chkd. YYYY.MM.DD

Project No.: 18017

Revision: 01

Sheet: 10 of 13

Drawing No.

C10



N.C. One-Call Center
Dial 811 or 1-800-632-4949

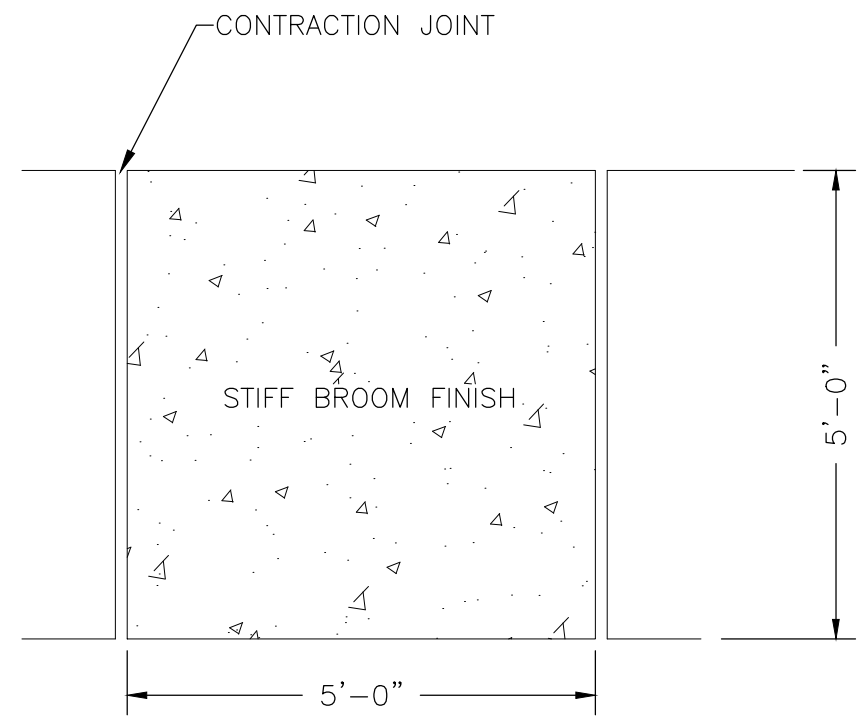

- NOTES:
1. PROPOSED CONCRETE SIDEWALK SHALL BE CONSTRUCTED ON SUFFICIENTLY COMPACTED SUBGRADE AS SPECIFIED. A MINIMUM OF 2" LAYER OF COMPACTED ABC STONE SHALL BE INSTALLED AS A LEVELING BASE FOR THE CONCRETE SIDEWALK. WHERE THICKER SECTIONS OF EXISTING CONCRETE SIDEWALK OR CURBING HAVE BEEN DEMOLISHED AND REMOVED, THE CONTRACTOR SHALL USE COMPACTED ABC STONE TO CREATE A LEVEL SUBGRADE. COSTS ASSOCIATED WITH THIS WORK SHALL BE INCLUDED IN THE PRICE BID FOR COMPACTED ABC STONE.
 2. PROPOSED SIDEWALK SHALL BE 4,000 PSI-STRENGTH CONCRETE AT 28 DAYS.
 3. CONTRACTION JOINTS SHALL BE 1" DEEP WITH 1/8" RADII IN THE CONCRETE SIDEWALK AT 5' INTERVALS.
 4. ONE 1/2" TRANSVERSE EXPANSION JOINT WILL BE REQUIRED AT 50' INTERVALS.
 5. A 1/2" ISOLATION JOINT WILL BE REQUIRED WHERE THE SIDEWALK JOINS ANY RIGID STRUCTURE, INCLUDING CURB AND GUTTER.
 6. EXPANSION AND ISOLATION JOINTS SHALL BE FILLED WITH APPROVED JOINT FILLER AND SEALED WITH APPROVED JOINT SEALER THAT CONFORMS TO ASTM C920.

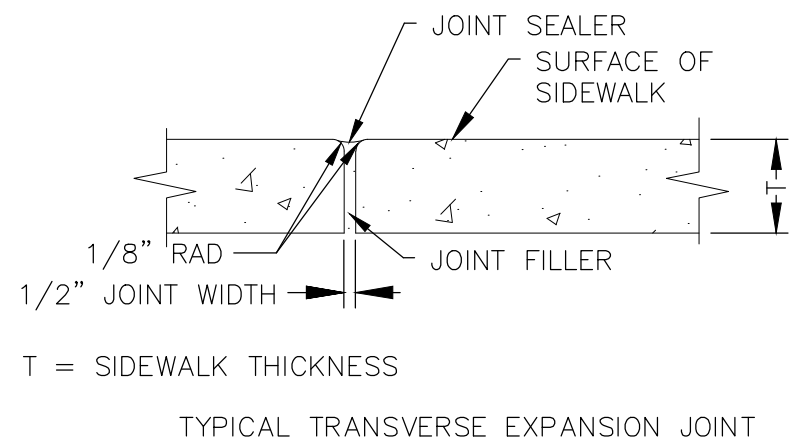
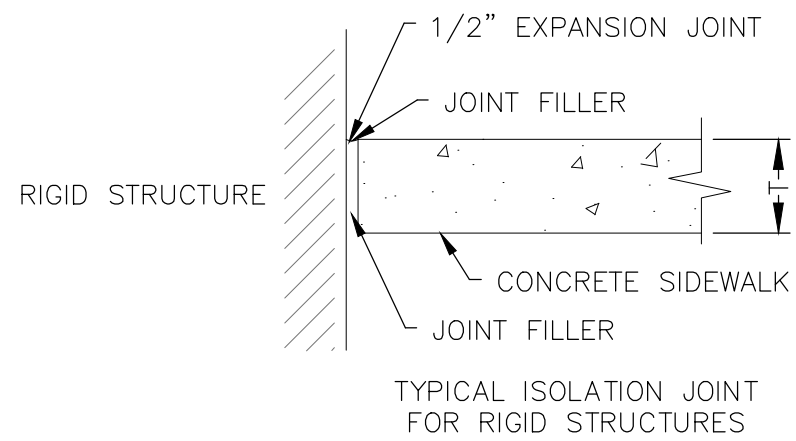
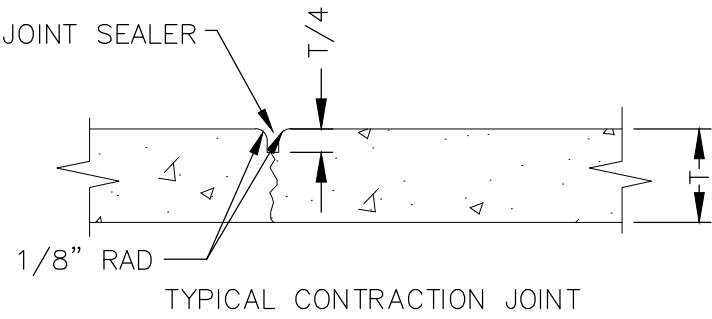
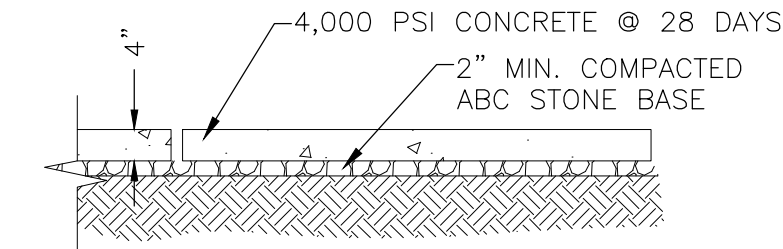

1
11 CONCRETE SIDEWALK DETAIL
N.T.S.

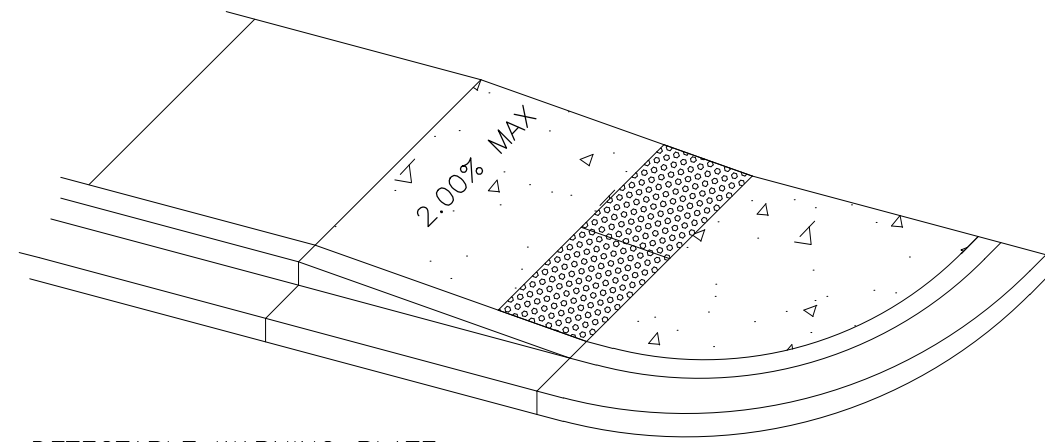

- NOTES:
- CURB RAMPS REQUIRE A (4'-0") MINIMUM LANDING WITH A MAXIMUM CROSS SLOPE AND LONGITUDINAL SLOPE OF 2.00% WHERE PEDESTRIANS PERFORM TURNING MANEUVERS. SLOPE TO DRAIN TO CURB.

2
11 PEDESTRIAN RAMP DETAIL TYPE 2A (MOD)
N.T.S.

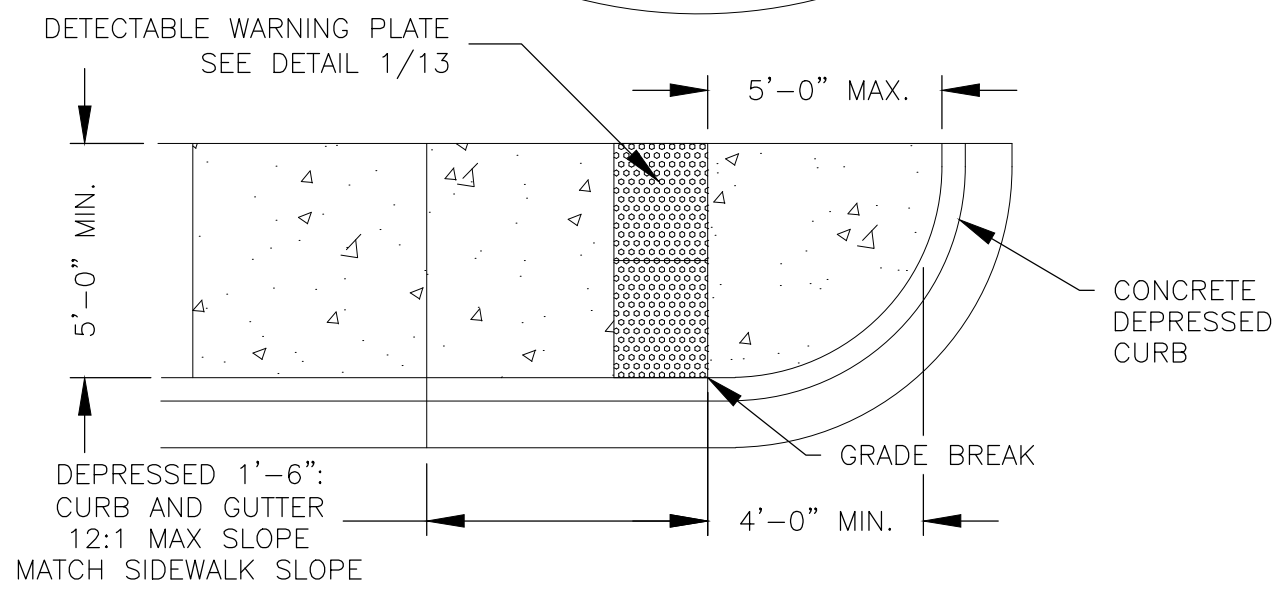

- NOTES:
- CURB RAMPS REQUIRE A (4'-0") MINIMUM LANDING WITH A MAXIMUM CROSS SLOPE AND LONGITUDINAL SLOPE OF 2.00% WHERE PEDESTRIANS PERFORM TURNING MANEUVERS. SLOPE TO DRAIN TO CURB.

3
11 PEDESTRIAN RAMP DETAIL TYPE 1
N.T.S.

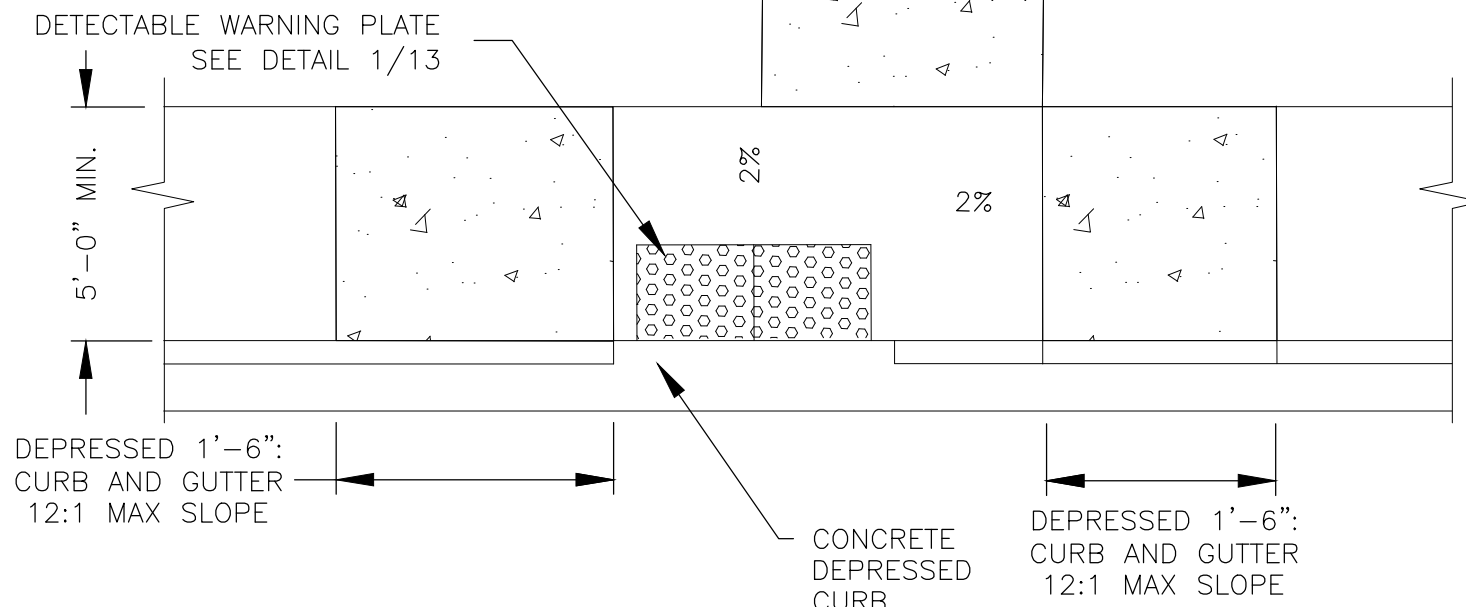

- NOTES:
- CURB RAMPS REQUIRE A (4'-0") MINIMUM LANDING WITH A MAXIMUM CROSS SLOPE AND LONGITUDINAL SLOPE OF 2.00% WHERE PEDESTRIANS PERFORM TURNING MANEUVERS. SLOPE TO DRAIN TO CURB.

4
11 PEDESTRIAN RAMP DETAIL TYPE 2 (MOD)
N.T.S.

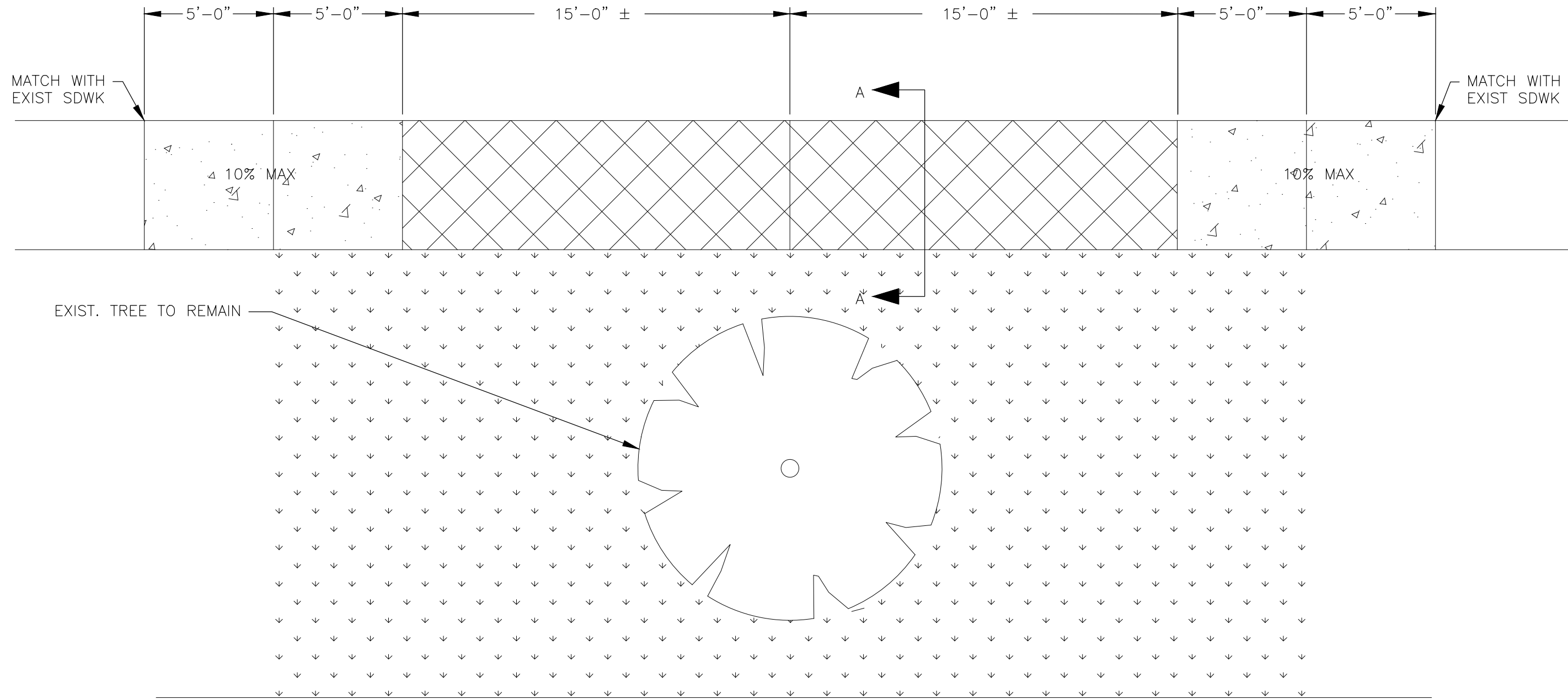

PLAN VIEW

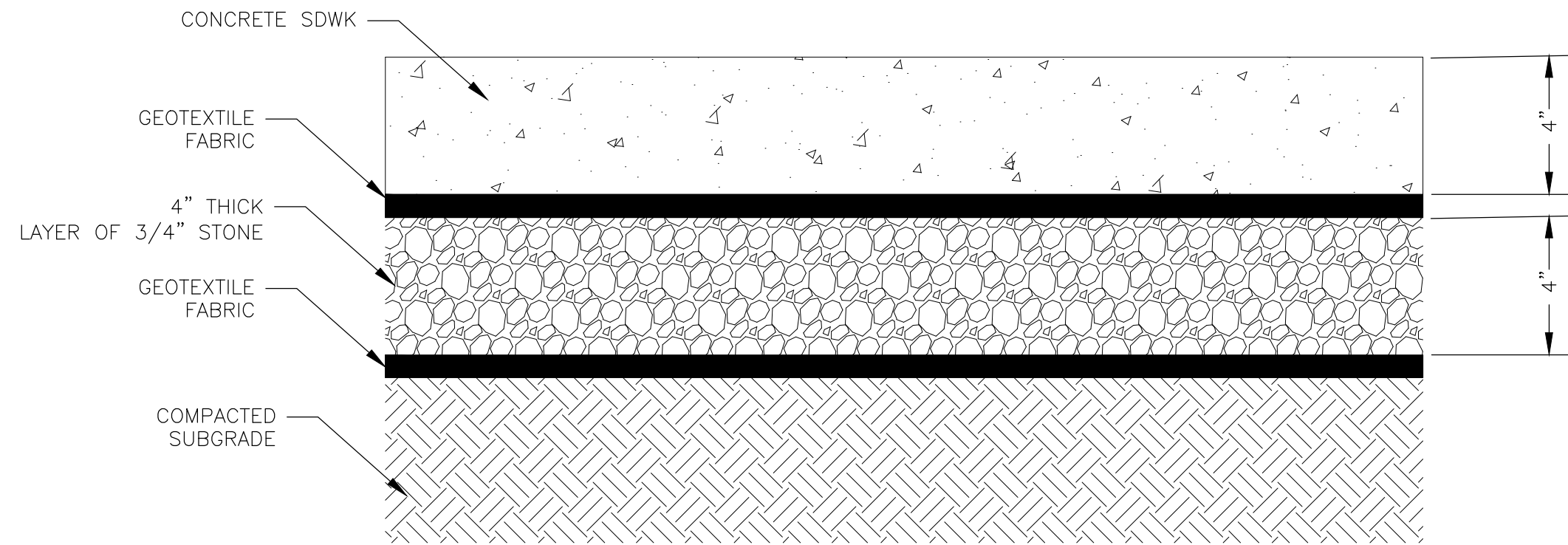

SECTION A-A

- NOTE:
- THE EXTENTS OF THE GEOTEXTILE FABRIC WILL VARY DEPENDING ON THE EXISTING TREE ROOTS. IT IS THE CONTRACTORS' RESPONSIBILITY TO MAKE SURE THAT THE TREE ROOT INTEGRITY IS PRESERVED DURING THE INSTALLATION PROCESS.

6
11 ROOT BARRIER PROTECTION
N.T.S.

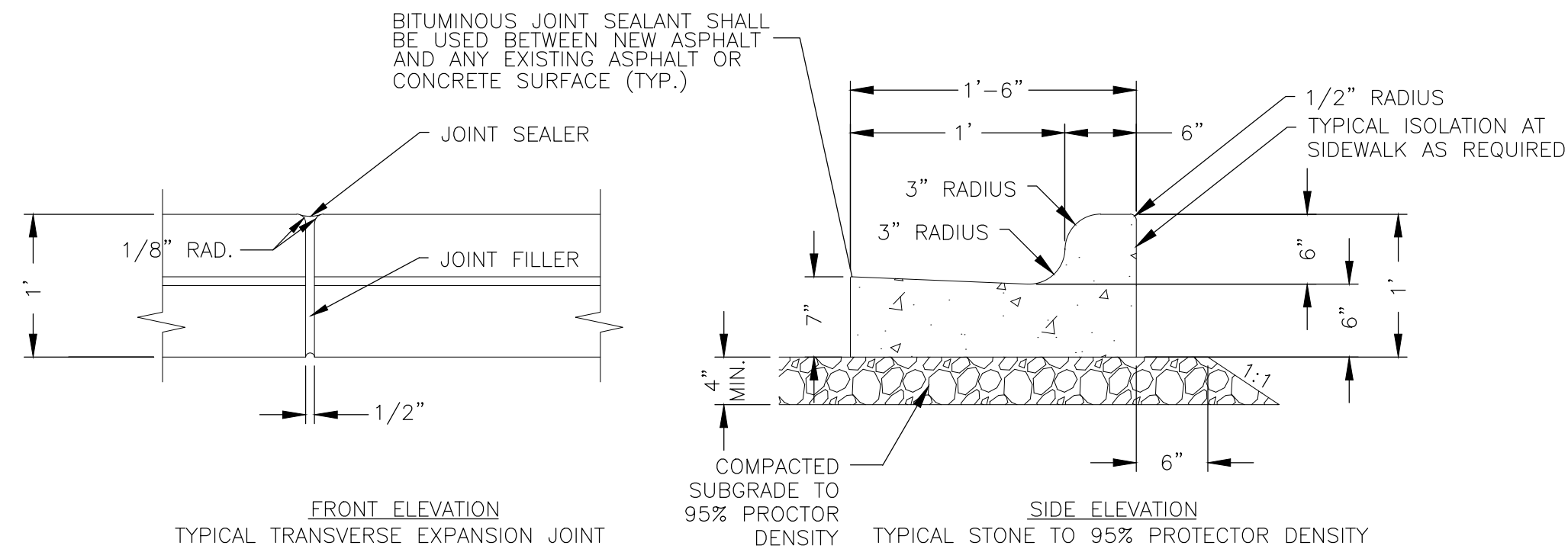

- NOTES:
1. PROPOSED CONCRETE CURB AND GUTTER SHALL BE CONSTRUCTED ON SUFFICIENTLY COMPACTED SUBGRADE AS SPECIFIED. A MINIMUM OF 4" LAYER OF COMPACTED ABC STONE SHALL BE INSTALLED AS A LEVELING BASE FOR THE CONCRETE CURB AND GUTTER. WHERE THICKER SECTIONS OF EXISTING CONCRETE SIDEWALK OR CURBING HAVE BEEN DEMOLISHED AND REMOVED, THE CONTRACTOR SHALL USE COMPACTED ABC STONE TO CREATE A LEVEL SUBGRADE. COSTS ASSOCIATED WITH THIS WORK SHALL BE INCLUDED IN THE PRICE BID FOR COMPACTED ABC STONE.
 2. PROPOSED CONCRETE CURB AND GUTTER SHALL BE 4,000 PSI-STRENGTH CONCRETE AT 28 DAYS.
 3. CONTRACTION JOINTS SHALL BE SPACED AT 10' INTERVALS. (A 15' SPACING WILL BE ALLOWED WHEN A MACHINE IS USED.)
 4. CONTRACTION JOINTS MAY BE INSTALLED WITH THE USE OF TEMPLATES OR FORMED BY OTHER APPROVED METHODS.
 5. TRANSVERSE EXPANSION JOINTS SHALL BE PLACED AT 90' INTERVALS.
 6. LONGITUDINAL JOINTS SHALL BE PLACED BETWEEN CURB AND GUTTER AND ANY EXISTING OR NEW ASPHALT ROAD SURFACE.
 7. A 1/2" ISOLATION JOINT WILL BE REQUIRED WHERE THE CURB AND GUTTER JOINS ANY RIGID STRUCTURE, INCLUDING SIDEWALK.
 8. FILL ALL JOINTS WITH APPROVED JOINT FILLER AND SEAL ALL JOINTS WITH APPROVED JOINT SEALER THAT CONFORMS TO ASTM C920.

5
11 18" CURB AND GUTTER
N.T.S.

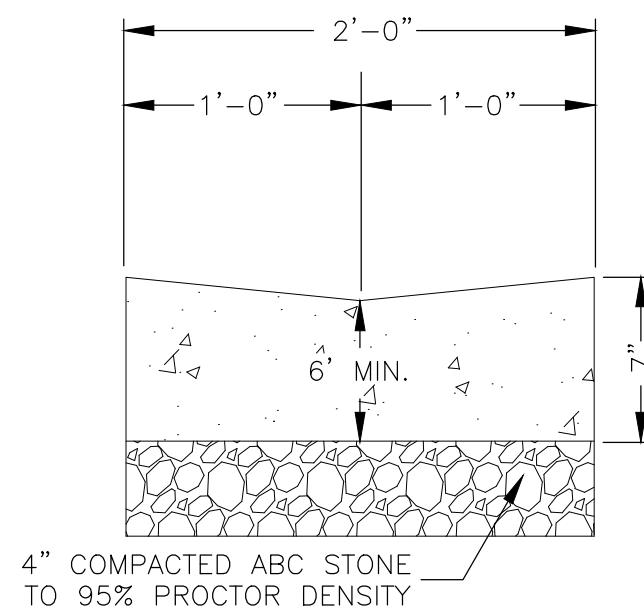
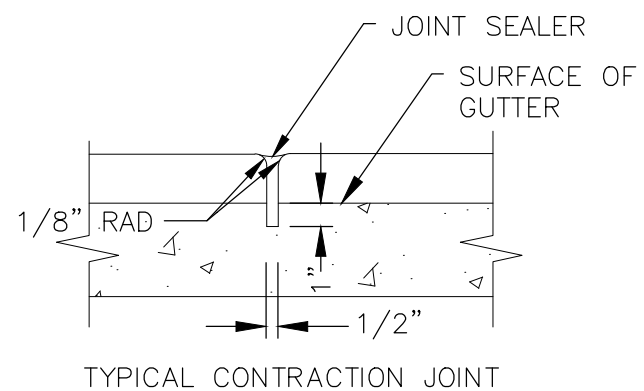

7
11 VALLEY GUTTER
N.T.S.



CITY OF HENDERSONVILLE, NC
"The City of Four Seasons"

City of Hendersonville Engineering Department
305 Williams Street
Hendersonville, NC 28792
(828) 697-3000 (office)
(828) 697-3066 (fax)
www.cityofhendersonville.org

CHERRY & BEECH SIDEWALK IMPROVEMENTS

DETAILS

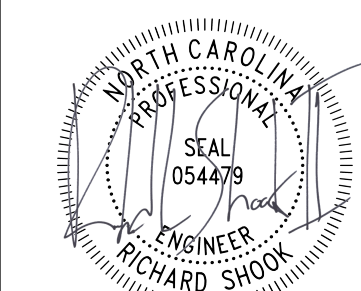

JMB, RLS, CC 2025.02.21
Dwn. Dsgn. Chkd. YYYY.MM.DD
Project No.: 18017
Revision: 101
Sheet: 11 of 13
Drawing No.
C11

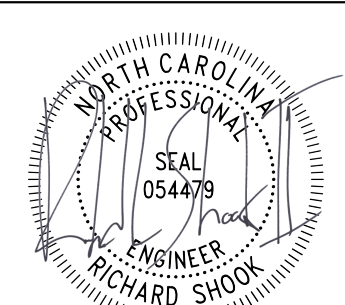
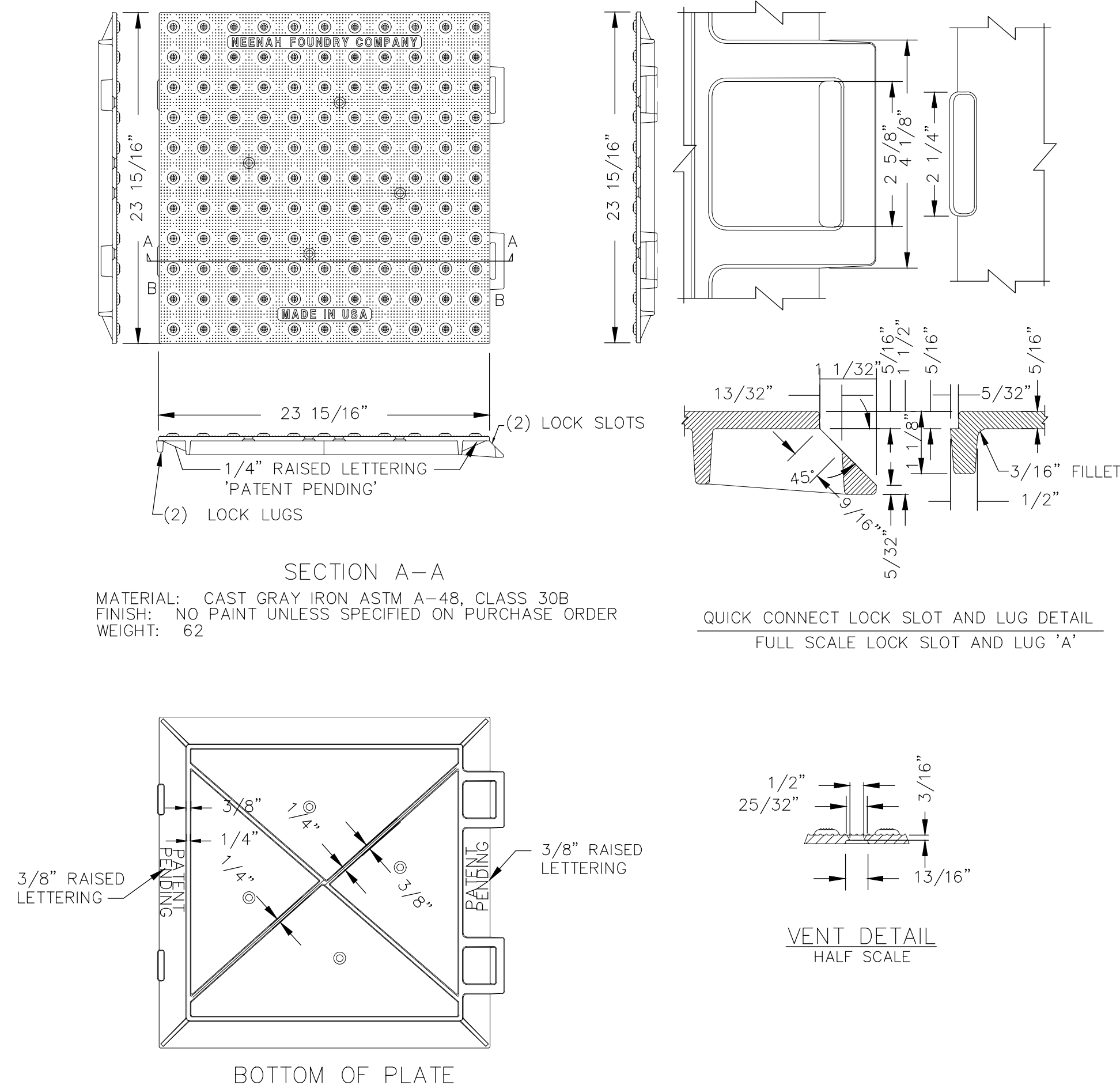
[illegible]C12

1
12

DETECTABLE WARNING PLATE DETAIL 1
N.T.S.

2
12

DETECTABLE WARNING PLATE DETAIL 2
N.T.S.

1. IF ADDITIONAL COVERAGE IS NEEDED, USE THE ASSEMBLY PROCEDURES BELOW TO CONNECT DETECTABLE WARNING PLATES TOGETHER.
2. USE SUPPLIED LIFTING SPRINGS.
3. PLATES CAN BE LIFTED WITH ITEMS SUCH AS 2X4 LUMBER, METAL PIPE, OR IRON TUBE.
4. POUR CONCRETE.
5. SET PLATES IN WET CONCRETE AT FINAL POSITION.
6. REMOVE LIFTING SPRINGS.
7. PRESS ASSEMBLY INTO WET CONCRETE TO FINAL ELEVATION.
8. FINISH CONCRETE AROUND ASSEMBLY.
9. BE SURE TO NOT GET CONCRETE ON THE PLATE SURFACE.

LAY OUT THE TWO PLATES SIDE BY SIDE SO THE LETTERING IS FACING IN THE SAME DIRECTION, PLACE PLATE 'B' LOCK TABS ON TOP OF PLATE 'A' LOCK SLOTS (SEE FIGURE 1).

ONCE THE CONNECTION IS COMPLETE, PLACE THE TWO PLATES BACK DOWN. ATTACH THE LIFTING SPRINGS NEARER TO THE ENDS OF THE ASSEMBLED PLATES (SEE FIGURE 3).

K LUGS

(2) ASSEMBLED JOINT

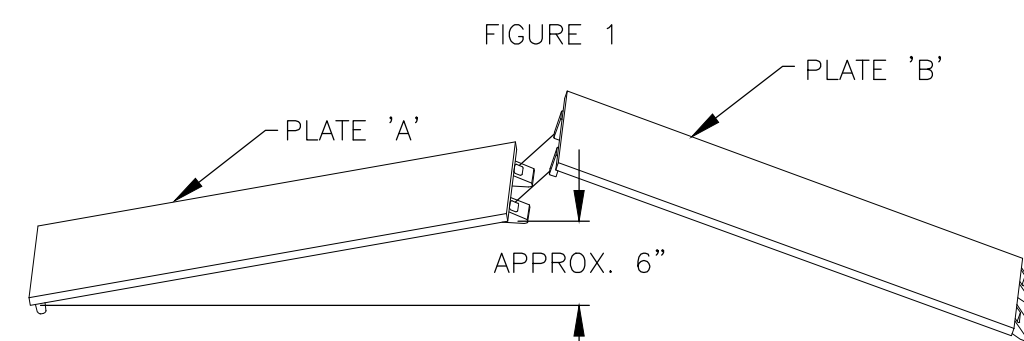
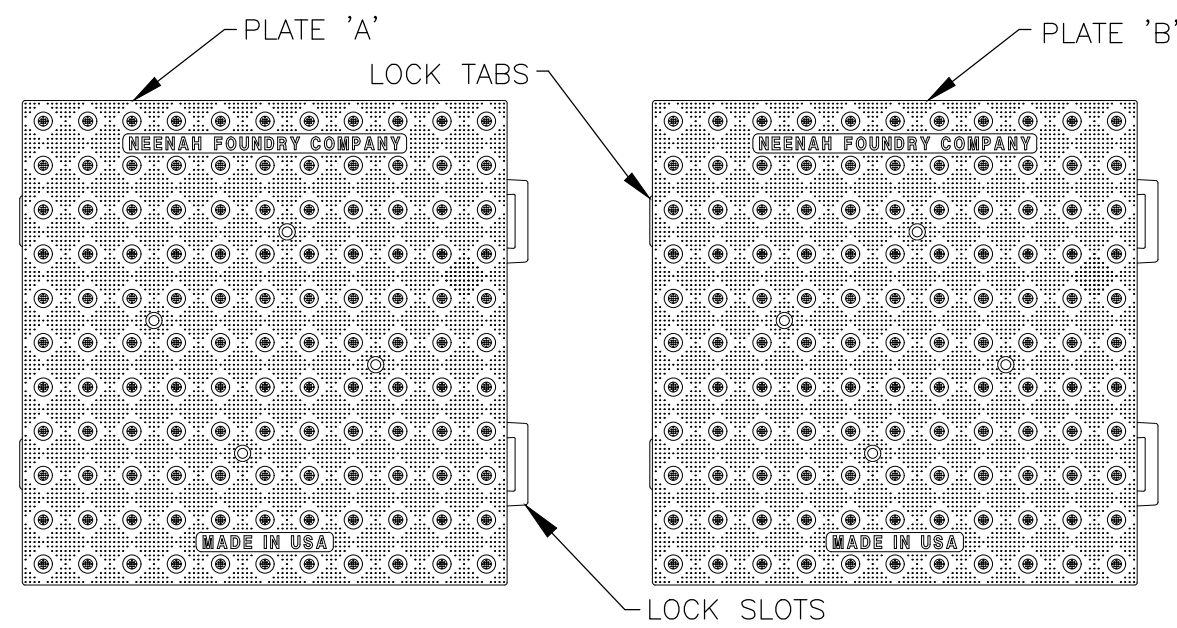

FIGURE 2

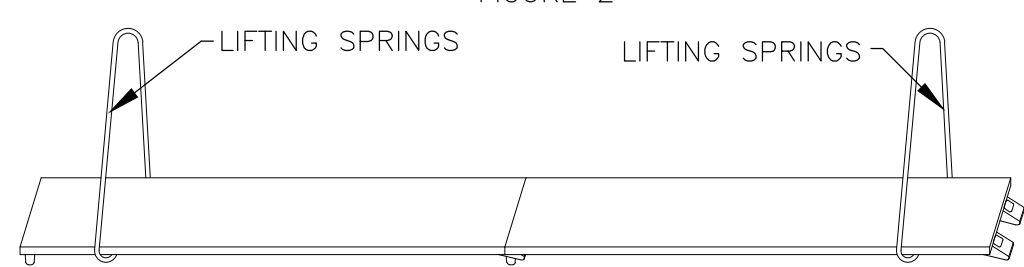

FIGURE 3

SECTION VIEW OF COMPLETED
DETECTABLE WARNING PLATE ASSEMBLY
FIGURE 6

